



INSTALLATION INSTRUCTIONS FOR PART 95-3304

APPLICATIONS

**2005-2007 Chevrolet Uplander
2005-2007 Buick Terraza
2005-2006 Saturn Relay
2005-2007 Pontiac Montana (SV6 only)
2005-2007 Chevrolet Corvette
2006-2007 Hummer H3**

95-3304



KIT FEATURES

- DDIN Head Unit Provision
- STACKED ISO DIN Head Unit Provision

KIT COMPONENTS

A) Trim Plate | B) Brackets

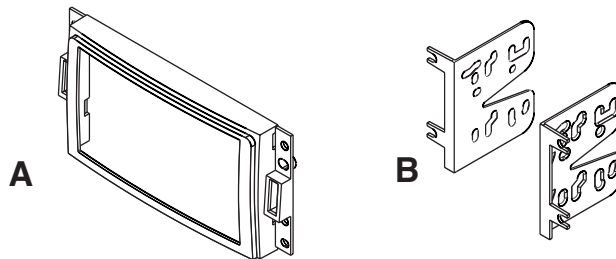

TOOLS REQUIRED:

Socket Wrench • Flat Blade Screwdriver • Phillips Screwdriver

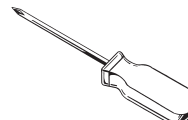
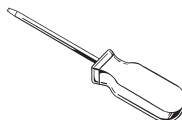
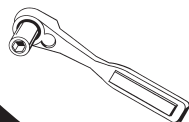

1-800-221-0932



www.metraonline.com

© COPYRIGHT 2004-2007 METRA ELECTRONICS CORPORATION



95-3304

TABLE OF CONTENTS

<i>Dash Disassembly</i>	<i>1-3</i>
<i>Kit Assembly</i>	<i>4-5</i>
<i>Final Assembly</i>	<i>6</i>

95-3304

CHEVY UPLANDER, PONTIAC MONTANA SV6, BUICK TERRAZA 2005-2007/ SATURN RELAY 2005-2006

- 1 Disconnect the negative battery terminal to prevent an accidental short circuit.
- 2 Unclip and remove trim panel around radio and a/c control. (Figure A)
- 3 Remove (8) 9/32" screws to extract radio and a/c control from sub dash. (Figure A)

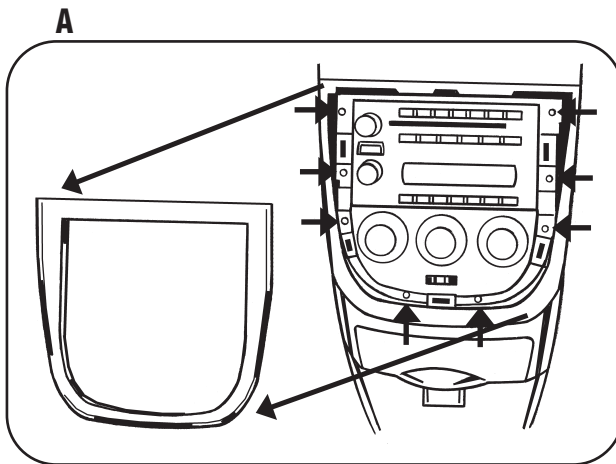

DASH DISASSEMBLY

2005-2007 CHEVROLET CORVETTE

- 1 Disconnect the negative battery terminal to prevent an accidental short circuit.
- 2 Unclip and remove ride control switch/blank plate at front edge of center console lid. (Figure A)
- 3 Remove (2) 9/32" screws from under plate removed in step 2. (Figure A)
- 4 Unclip and remove entire panel surrounding radio and including a/c controls. (Figure A)
- 5 Remove (4) 9/32" screws securing radio to extract from sub dash. (Figure A)

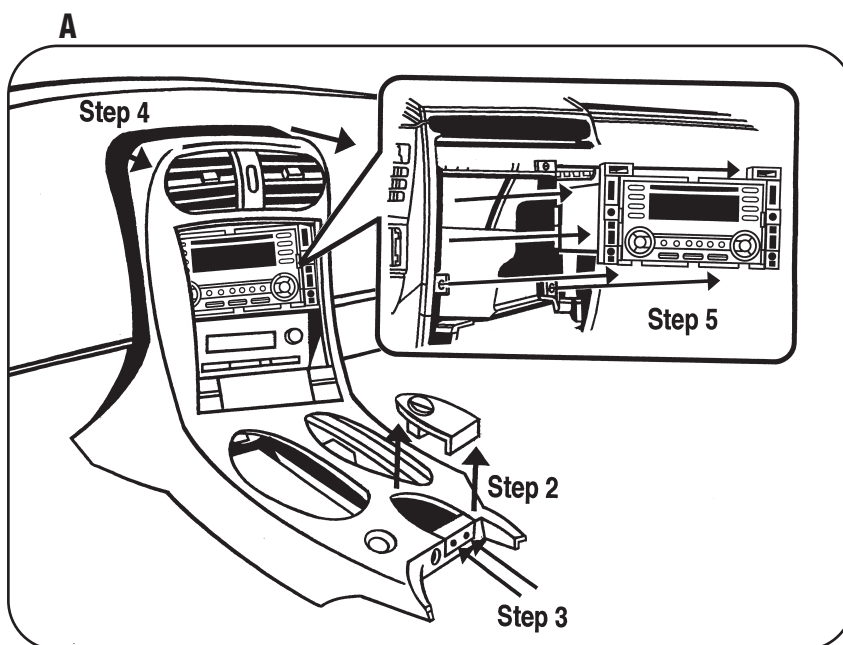

2006-2007 HUMMER H3

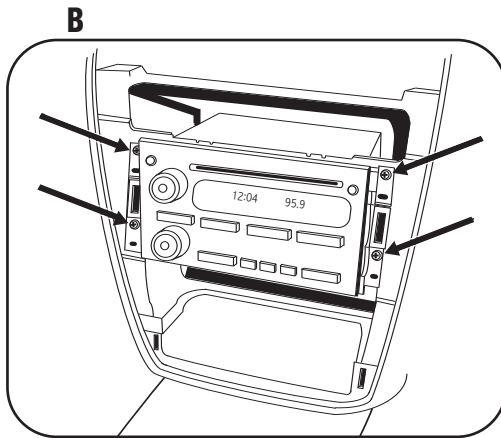
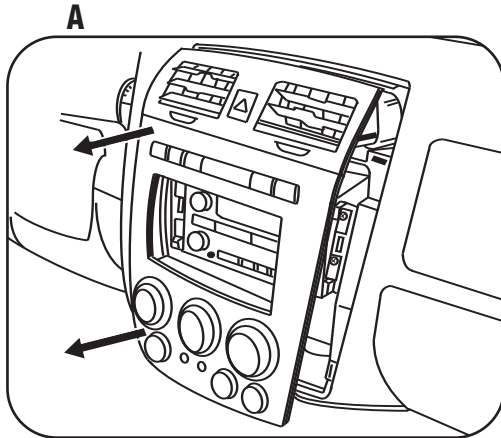

- 1 Disconnect the negative battery terminal to prevent an accidental short circuit.
- 2 Unclip and remove trim panel around radio and a/c controls. (Figure A)
- 3 Remove (4) 9/32" screws securing radio. (Figure B)
- 4 Unplug and remove radio.

DASH DISASSEMBLY

DOUBLE DIN HEAD UNIT PROVISION

- 1 Slide the appropriate bracket into the trim plate aligning the holes in the trim plate to the clips on the bracket. (Figure A)
- 2 Slide the DDIN radio unit into the trim plate bracket assembly and secure the unit to the kit using the screws supplied with the head unit. (Figure B)

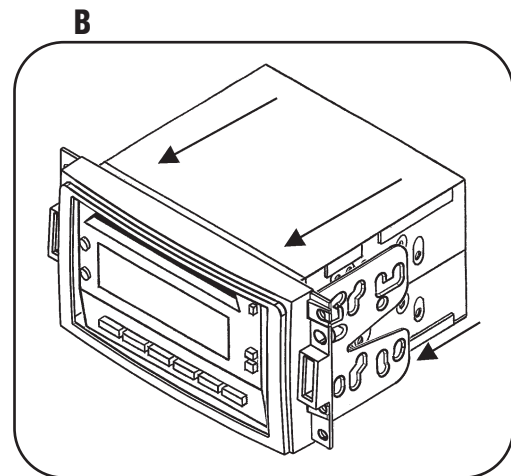
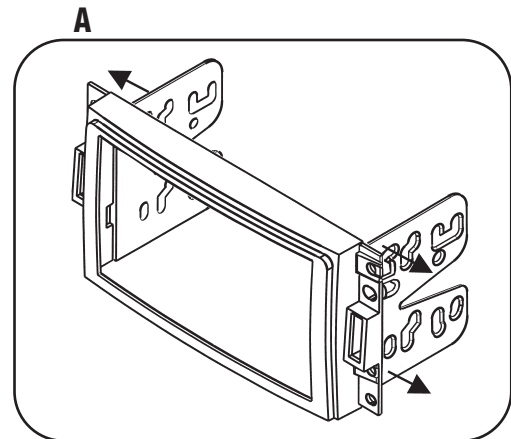

STACKED ISO DIN HEAD UNIT PROVISION

- 1 Slide the appropriate bracket into the trim plate aligning the holes in the trim plate to the clips on the bracket. (Figure A)
- 2 Slide the stacked ISO DIN units into the trim plate bracket assembly and secure the unit to the kit using the screws supplied with the head unit. (Figure B)

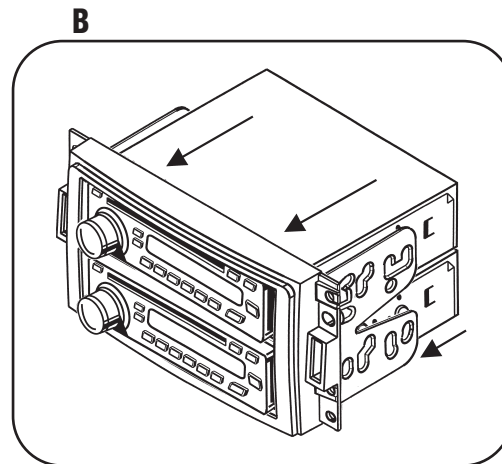
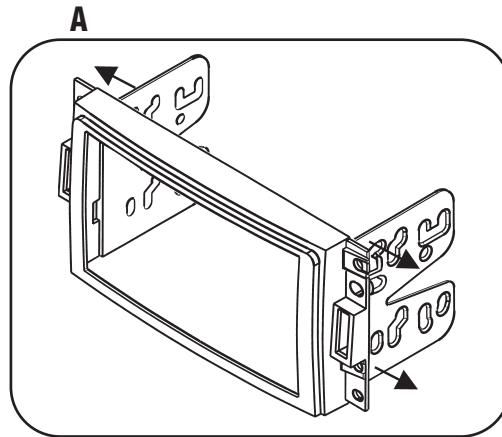

KIT ASSEMBLY

FINAL ASSEMBLY

- 1** Locate the factory wiring harness in the dash and make the connection as shown. Metra recommends using the proper mating adapter and making the connections as shown. (Isolate and individually tape off the ends of any unused wires to prevent electrical short circuit.)
- 2** Re-connect the negative battery terminal and test the unit for proper operation.
- 3** Reassemble radio and dash assemblies in reverse order of disassembly.

FINAL WIRING CONNECTIONS

Make wiring connections using the EIA color code chart shown below and the instructions included with the head unit. Metra recommends making connections as shown below; Strip, Splice, Solder, Tape. Isolate and individually tape off ends of any unused wires to prevent electrical short circuit.

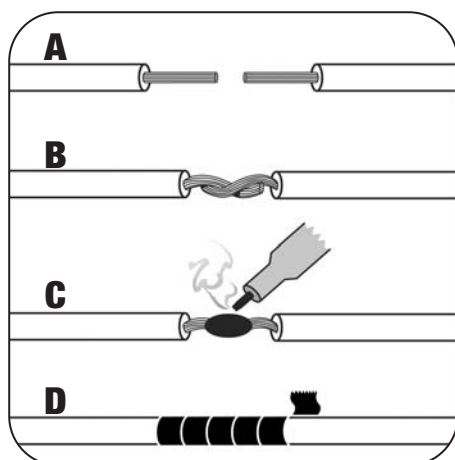

- A) Strip wire ends back 1/2"**
- B) Twist ends together**
- C) Solder**
- D) Tape**

METRA / EIA WIRING CODE

12V Ignition / Acc . . . Red

12V Batt / Memory . . Yellow

Ground Black*

Power Antenna Blue

Amp Turn-On Blue / White

Amp Ground Black / White

Illumination Orange

Dimmer Orange / White

Right Front (+) Gray

Right Front (-) Gray / Black

Left Front (+) White

Left Front (-) White / Black

Right Rear (+) Violet

Right Rear (-) Violet / Black

Left Rear (+) Green

Left Rear (-) Green / Black

***NOTE:** When Black a wire is not present, ground radio to vehicle chassis.

All colors may not be present on all leads due to manufacturer's specifications.



This image shows a full page of blank, lined paper. It features approximately 28 horizontal blue or grey lines spaced evenly apart, typical of notebook paper. The lines extend across the entire width of the page, leaving small margins at the top and bottom. There are no vertical lines, text, or other markings on the page.



NOTES

Lined area for notes, consisting of multiple horizontal lines.



NOTES

This image shows a full page of white paper with horizontal blue or grey ruling lines. The lines are evenly spaced and run across the width of the page, typical of notebook paper. There are no margins, text, or other markings on the page.

95-3304 INSTRUCTIONS



1-800-221-0932



www.metraonline.com

REV. 06/26/07

© COPYRIGHT 2004 METRA ELECTRONICS CORPORATION

INST95-3304