

99-7502



Radio
Housing



ISO
Trimplate



ISO Snap In
Brackets



KIT COMPONENTS

VEHICLE APPLICATIONS

MAZDA MPV 2000



Phillips
Screwdriver



TOOLS REQUIRED

KIT FEATURES

- DIN head unit provision with pocket
- ISO head unit provision with pocket

INSTALLATION INSTRUCTIONS

Questions?

Call the Help Line: **(800)253 TECH**

Monday - Friday 9:00 am - 7:00 pm EST

Saturday - Sunday 10:00 am - 4:00 pm EST

• Dash Disassembly	1
• Kit Features	
• DIN Head Unit Provision with Pocket Assembly	2
• ISO Head Unit Provision with Pocket Assembly	3
• Final Assembly	4

99-7502 • Mazda MPV 2000

Disconnect the negative battery terminal to prevent an accidental short circuit.

Remove (2) phillips screws from above the instrument cluster. **1**

See figure **A**

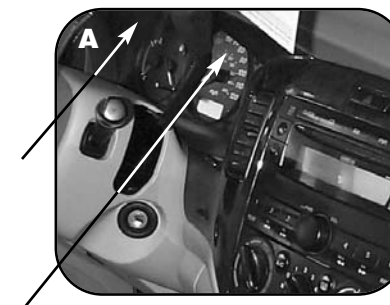

Unsnap and remove radio bezel. **2**

See Figure **B**.



Remove (4) phillips screws to remove radio. **3**

See Figure **C**.



99-7502 • Mazda MPV 2000

99-7502 • Mazda MPV 2000

DIN HEAD UNIT PROVISION WITH POCKET

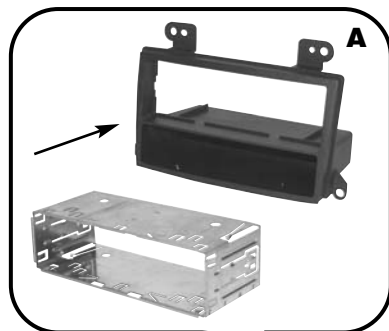

- 1** Slide the DIN cage into the **Radio Housing** and secure by bending the metal locking tabs down.

See figure **A**

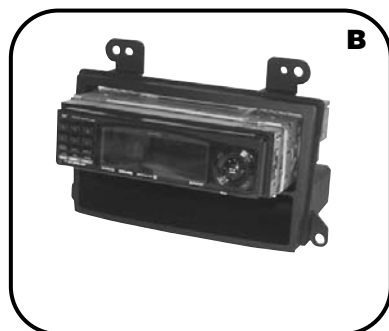

- 2** Slide the aftermarket head unit into the cage and secure.

See Figure **B**

- 3** Continue to Final Assembly

- Align the holes in the **ISO Snap In Brackets** with the holes in the head unit and mount the brackets to the head unit with the screws supplied with the unit.

See figure **A**

- Slide the head unit/bracket assembly into the radio opening until the side clips engage.

See Figure **B**

- Snap the **ISO Trimplate** over the head unit.

See Figure **C**.

Continue to Final Assembly

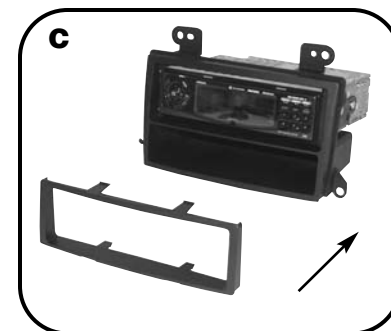
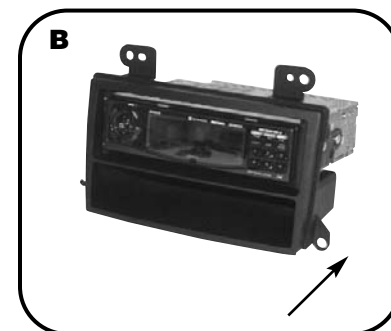
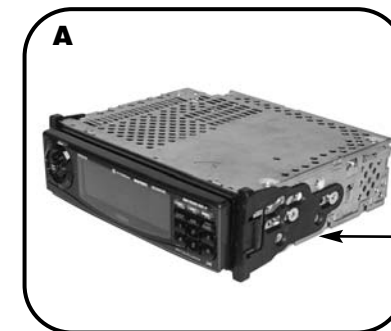

ISO HEAD UNIT PROVISION WITH POCKET

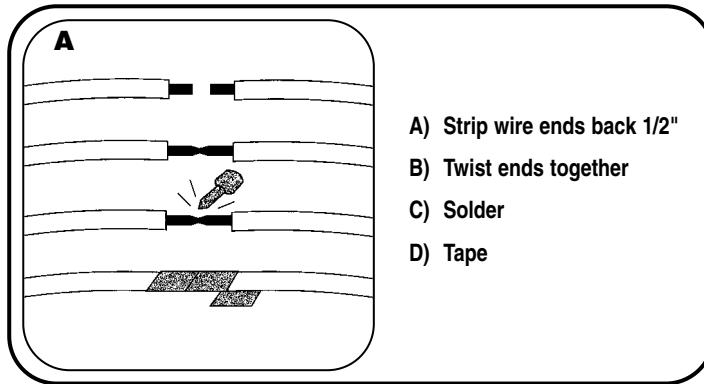

- 1 Locate the factory wiring harness in the dash. Metra recommends using the proper mating adapter and making connections as shown. (Isolate and individually tape off the ends of any unused wires to prevent electrical short circuit.)
See figure **A**
- 2 Re-connect the battery terminal and test the unit for proper operation.
- 3 Reassemble dash in the reverse order of your specific vehicle's **Dash Disassembly** on page 1-2.