



INSTALLATION INSTRUCTIONS FOR PART 99-78775

APPLICATIONS

Honda Fit 2009

99-78775

KIT FEATURES

- DIN Radio Provision with Pocket
- ISO Mount Radio Provision with Pocket
- Double DIN Radio Provision
- Stacked ISO Mount Units Provision
- **Painted To Match Factory Dash**
"S"= SILVER



KIT COMPONENTS

- A) Radio Housing • B) ISO Brackets • C) ISO Trim Plate • D) Double DIN Brackets
- E) Double DIN Trim Plate • F) Pocket

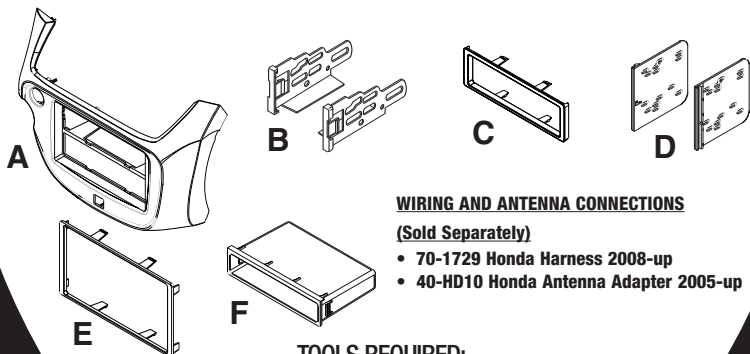

WIRING AND ANTENNA CONNECTIONS

(Sold Separately)

- 70-1729 Honda Harness 2008-up
- 40-HD10 Honda Antenna Adapter 2005-up

TOOLS REQUIRED:

Small Flat Blade Screwdriver/ Panel Removal Tool

- Phillips Screwdriver • Socket Set



1-800-221-0932



www.metraonline.com

© COPYRIGHT 2009 METRA ELECTRONICS CORPORATION



99-78775

TABLE OF CONTENTS

Dash Disassembly

- Honda Fit 2009	1
-------------------------------	----------

Kit Assembly

- Kit Preparation	2
- DIN Radio Provision with Pocket	3
- ISO Mount Radio Provision with Pocket	4
- Double DIN Radio/ Stacked ISO Mount Units Provision	5

***Note:**

Refer also to the instructions included with the aftermarket radio.



KNOWLEDGE IS POWER

Enhance your installation and fabrication skills by enrolling in the most recognized and respected mobile electronics school in our industry. Log onto www.installerinstitute.com or call 800-354-6782 for more information and take steps toward a better tomorrow.

HONDA FIT 2009

- 1 Disconnect the negative battery terminal to prevent an accidental short circuit.
- 2 Unclip and remove the lower center panel below radio. (Figure A)
- 3 Remove (1) 8 MM bolt facing up behind center panel.
Note: Slide the recirculation control lever to FRESH for better access to bolt. (Figure A)
- 4 Open the upper glove box then use a pry tool to unclip and remove the radio/climate control assembly. (Figure B & C)
- 5 Remove (2) Phillips screws securing the hazard switch to the back of the factory radio panel. (Figure D)
- 6 Remove (2) Phillips screws securing the air bag light to the back of the factory radio panel. (Figure E)
- 7 Remove (5) Phillips screws securing the a/c vents to the radio panel.
- 8 Remove (7) retaining clips from radio housing to be used later in kit preparation.

Continue to kit preparation.

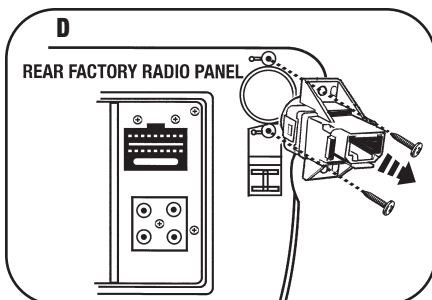
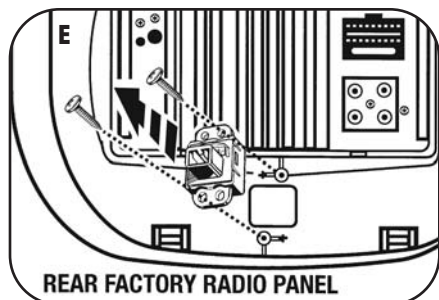
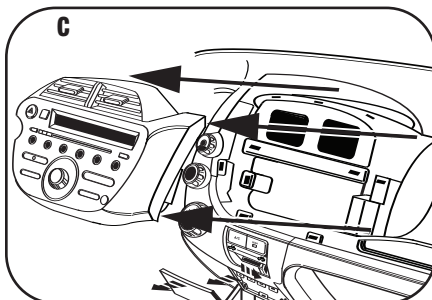
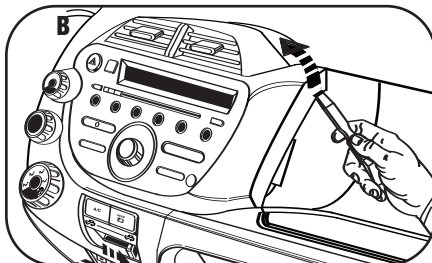
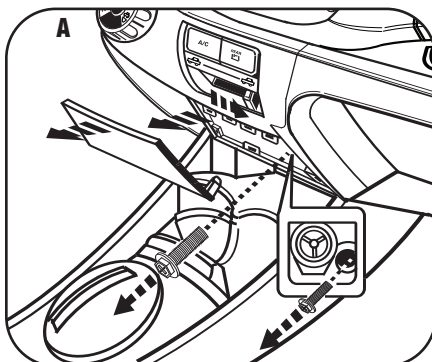

KIT PREPARATION

- 1** Secure the hazard switch into the radio housing panel using the factory hardware. (Figure A)
- 2** Secure the air bag light into the radio housing panel using the factory hardware. (Figure A)
- 3** Secure the a/c vents to the radio housing using the factory hardware. (Figure B)
- 4** Attach the (7) retaining clips to the radio housing panel in the same location as removed from the factory radio panel.

Continue to kit assembly.

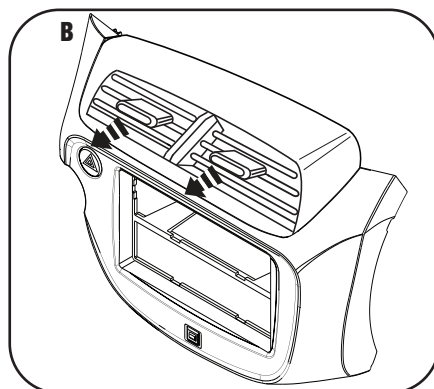
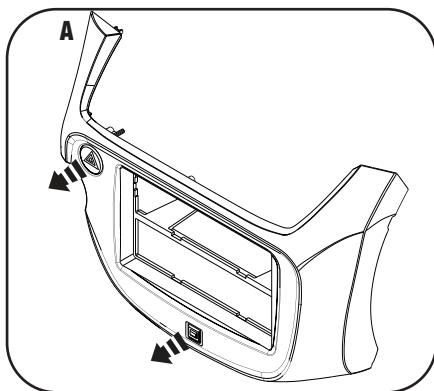

DIN MOUNT RADIO PROVISION WITH POCKET

**Note: Refer also to the instructions included with the aftermarket radio.*

- 1 Locate the factory wiring harness in the dash. Metra recommends using the proper mating adapter from Metra or AXCESS. Re-connect the negative battery terminal and test the unit for proper operation.
- 2 Slide the DIN cage into the Radio Housing and secure by bending the metal locking tabs down. (Figure A)
- 3 Slide the aftermarket head unit into the cage and secure. (Figure B)
- 4 Snap the pocket into the Radio Housing. (Figure C)
- 5 Re-assemble dash in reverse order of disassembly.

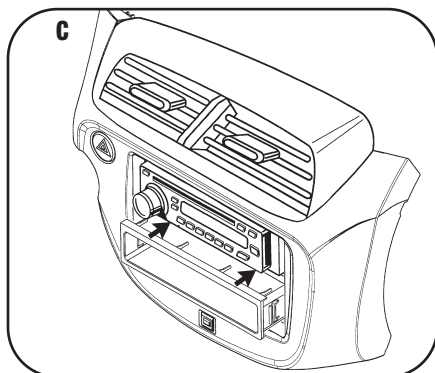
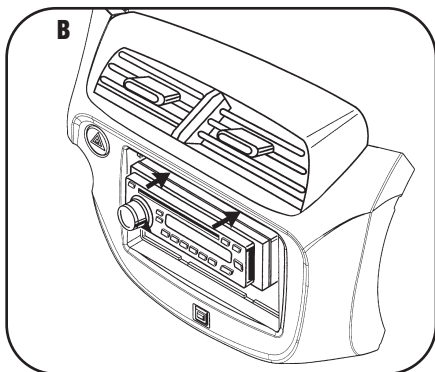
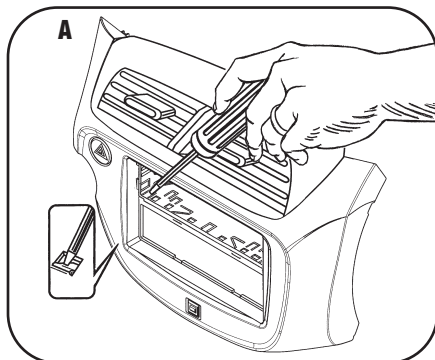



ISO MOUNT RADIO PROVISION WITH POCKET

**Note: Refer also to the instructions included with the aftermarket radio.*

- 1 Locate the factory wiring harness in the dash. Metra recommends using the proper mating adapter from Metra or AXCESS. Re-connect the negative battery terminal and test the unit for proper operation.
- 2 Mount the ISO Brackets to the head unit with the screws supplied with the unit. (Figure A)
- 3 Slide the head unit into the radio opening until the side clips engage. (Figure B)
- 4 Snap the Trim plate into the Radio Housing. (Figure B)
- 5 Snap the Pocket into the radio housing. (Figure C)
- 6 Re-assemble dash in reverse order of disassembly.

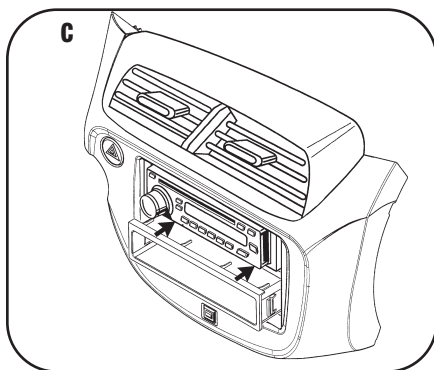
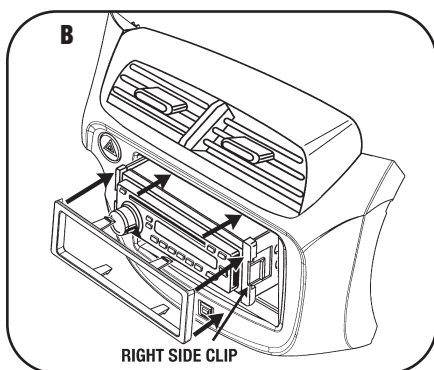
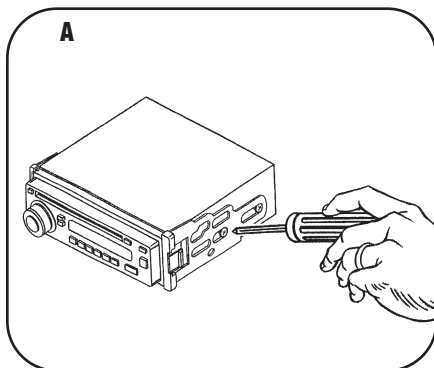



DOUBLE DIN RADIO PROVISION/ STACKED ISO MOUNT UNITS PROVISION

**Note: Refer also to the instructions included with the aftermarket radio.*

- 1 Locate the factory wiring harness in the dash. Metra recommends using the proper mating adapter from Metra or AXCESS. Re-connect the negative battery terminal and test the unit for proper operation.
- 2 Cut and remove the center bar from the radio housing. (Figure A)
- 3 Snap the Double DIN brackets to the inside edge of the Radio Housing. (Figure B)
- 4 Slide the Double DIN head unit or stacked ISO head units into the bracket/radio housing assembly and secure the Double DIN head unit or stacked ISO head units to the assembly using the screws supplied with the radio. (Figure C)
- 5 Snap the Double DIN trim plate onto the front of the radio/housing assembly. (Figure C)
- 6 Re-assemble dash in reverse order of disassembly.

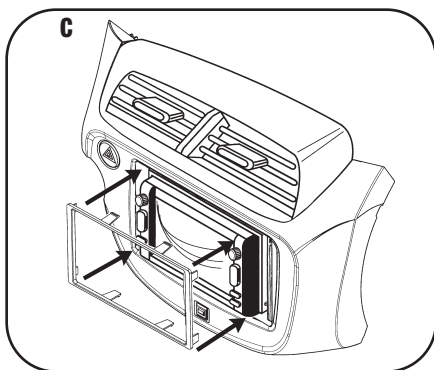
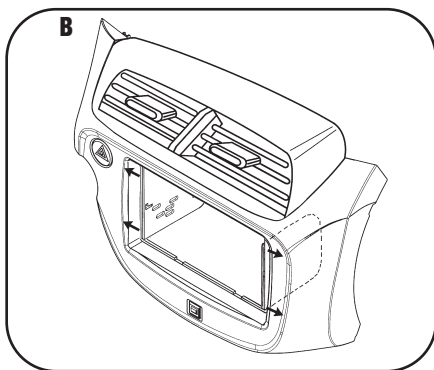
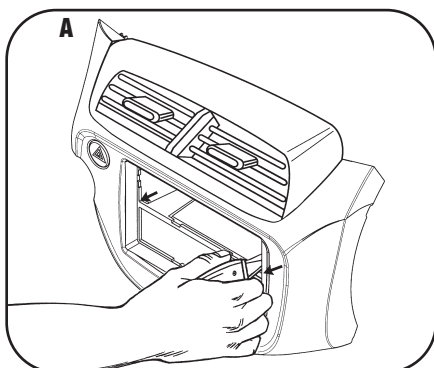

99-78775 INSTRUCTIONS



1-800-221-0932



www.metraonline.com

REV. 03/26/09 © COPYRIGHT 2009 METRA ELECTRONICS CORPORATION INST99-7877