

Locate the factory wiring harness in the dash. Metra recommends using the proper mating adaptor and making connections as shown. (Isolate and individually tape off the ends of any unused wires to prevent electrical short circuit).

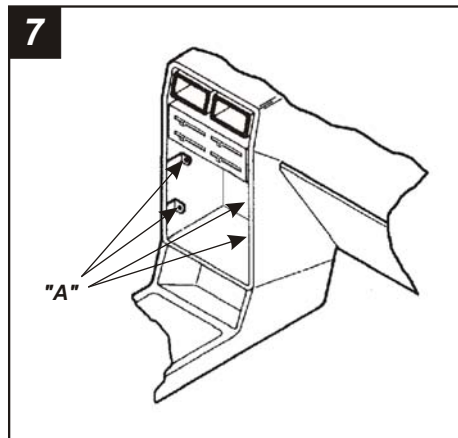

Locate the (4) mounting positions in the sub-dash ("A").

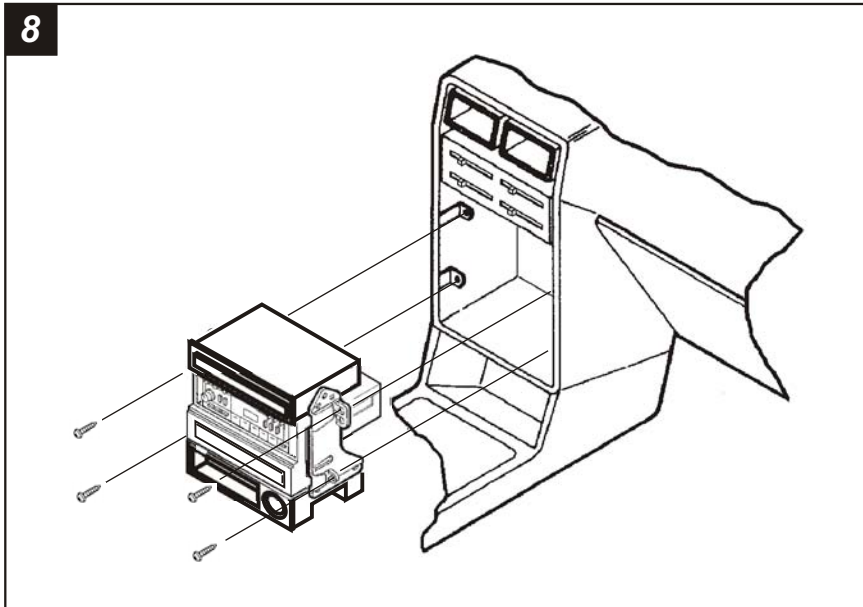

Re-connect the battery terminal and test the unit for proper operation. Mount the head unit/kit assembly to the sub-dash with (4) screws previously removed in step #1.

## KIT FEATURES

- ▶ Shaft and DIN unit provisions
- ▶ Equalizer provisions
- ▶ Factory cupholder provisions

## KIT COMPONENTS

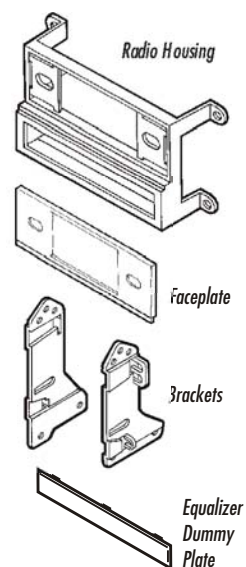

## TOOLS REQUIRED



# 99-8145 INSTALLATION INSTRUCTIONS

## APPLICATIONS

CAR	PAGE
TOYOTA	
Terrel 1987-90.....	1-3



## ALL VEHICLES

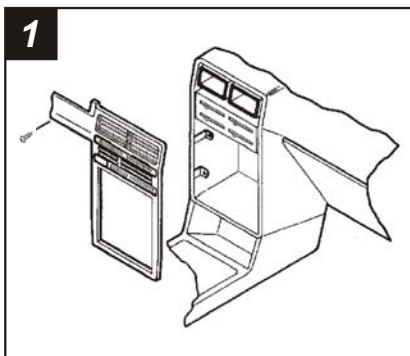

Disconnect the negative battery terminal to prevent an accidental short circuit. Remove (1) Phillips screw located above the ignition switch. Remove the climate control knobs. Unclip the dash trim bezel and remove. Remove (4) Phillips screws securing the factory head unit assembly and disconnect the wiring. Remove (2) screws securing the factory cupholder to the assembly and remove. Remove (4) screws securing the ashtray/cigarette lighter to the assembly and remove.

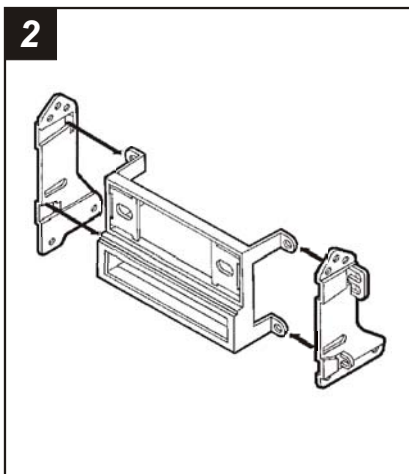

Insert the mounting tabs on the **Radio Housing** into the slots in the **Brackets**.

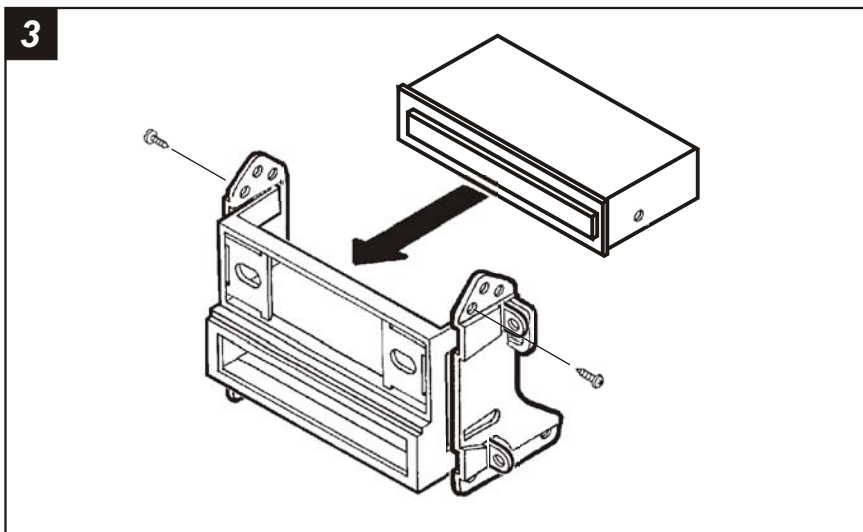

Place the factory cupholder above the **Radio Housing** and secure the cupholder to the **Brackets** with (2) screws previously removed in step #1.

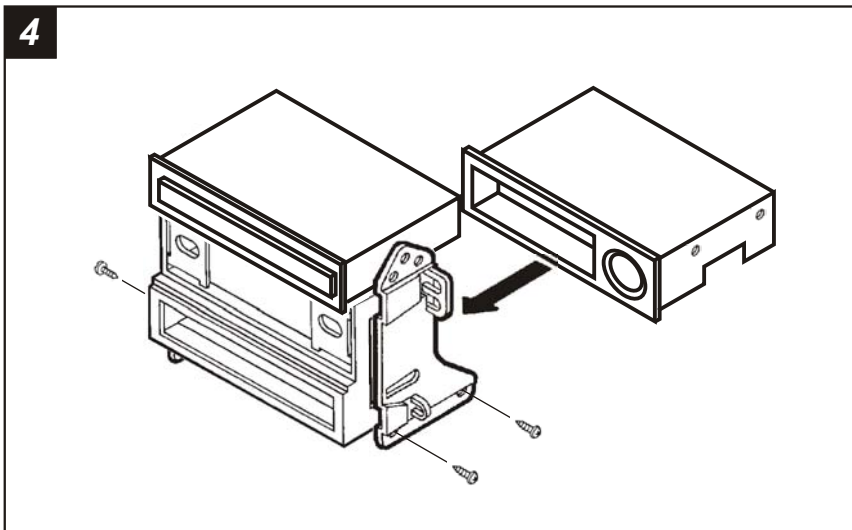

Place the factory ashtray/cigarette lighter below the **Radio Housing** and secure to the **Brackets** with (4) screws previously removed in step #1.

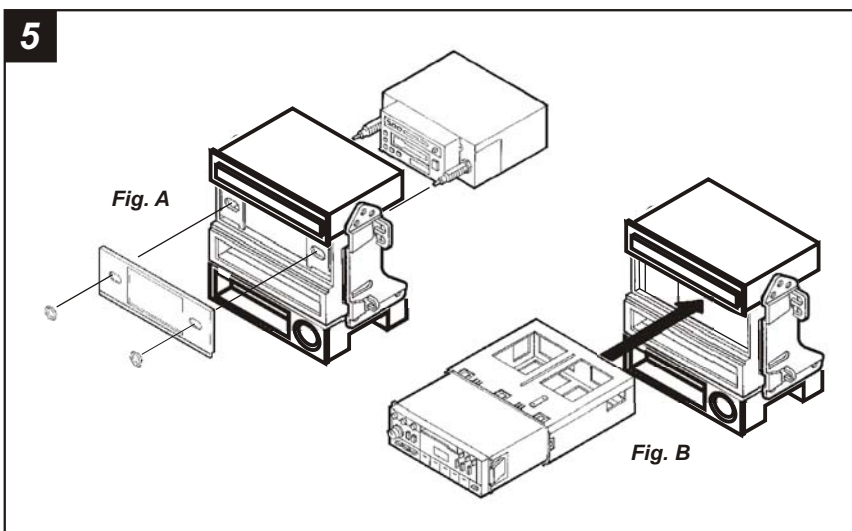

**2-SHAFT HEAD UNITS:** Attach the **Faceplate** to the **Radio Housing**. Slide the aftermarket head unit into the kit and secure with shaft nuts. (see Fig. A)

**DIN HEAD UNITS:** Cut and remove the shaft supports from the **Radio Housing**. Slide the DIN cage into the kit and secure by bending the metal locking tabs down. Slide the aftermarket head unit into the cage until secure. (see Fig. B)

(If an equalizer will be included, slide the unit into the back of the **Radio Housing** and secure. If an equalizer will NOT be included, snap the **Equalizer Dummy Plate** into the opening).