



## INSTALLATION INSTRUCTIONS FOR PART 99-8210

### APPLICATIONS

# Toyota 4-Runner Limited 2003-2007

# 99-8210

#### KIT FEATURES

- DIN Head Unit Provision with Pocket
- ISO DIN Head Unit Provision with Pocket

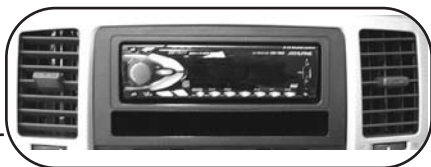

#### KIT COMPONENTS

A) Radio Housing • B) ISO Brackets • C) ISO Trim Plate

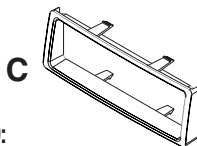
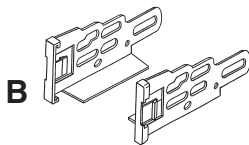
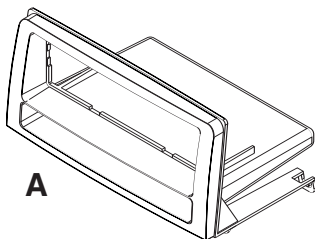

#### TOOLS REQUIRED:

Small Flat Blade Screwdriver/ Panel Removal Tool  
• Phillips Screwdriver • Socket Set



1-800-221-0932



[www.metraonline.com](http://www.metraonline.com)

© COPYRIGHT 2004-2007 METRA ELECTRONICS CORPORATION



## **TABLE OF CONTENTS**

### **Dash Disassembly**

**- Toyota 4-Runner Limited 2003-2007 ..... 1,2**

### **Kit Assembly**

**- DIN Head Unit Provision with Pocket ..... 3**

**- ISO DIN Head Unit Provision with Pocket ..... 4**

**Final Assembly ..... 5**

### **\*Note:**

**Refer also to the instructions included with the aftermarket radio.**

## Toyota 4-Runner Limited 2003-2007

**1** Disconnect the negative battery terminal to prevent an accidental short circuit.

**2** Unsnap and remove trim from around shifter. (Figure A)

**3** Unsnap and remove center console cover. (Figure B)

**4** Unsnap trim ring from around ignition key cylinder.

**5** Remove (1) 10 mm bolt from bottom right side of panel below steering column. Unsnap panel and pull away to gain access behind panel. (Figure C)

**6** Remove (1) 10 mm bolt on bottom left of center panel behind panel below steering column. (Figure D)

**A**

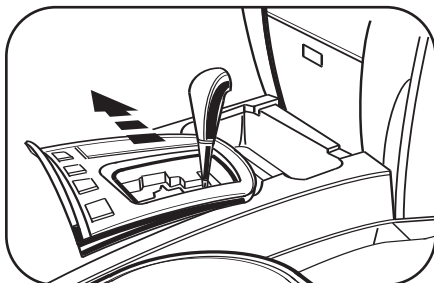

**B**

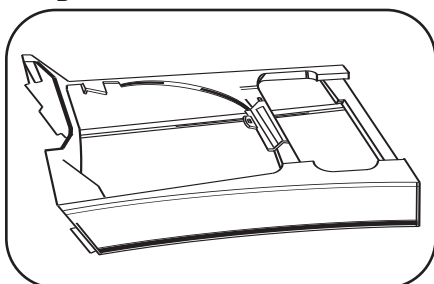

**C**

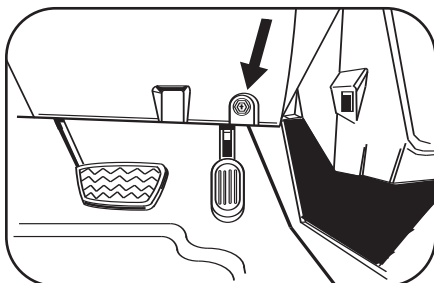

**D**

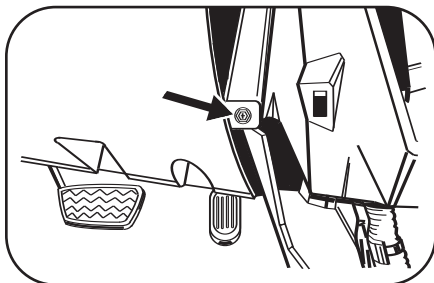

## Toyota 4-Runner Limited 2003-2007

- 7** Remove (1) 10 mm bolt beneath climate control behind pocket door.  
(Figure E) Unsnap climate control, unplug and remove climate control.  
(Figure F)

- 8** Remove (2) 10 mm bolts beneath radio behind climate controls.  
(Figure G)

- 9** Unsnap and remove entire center panel around radio.

- 10** Remove (2) 10 mm bolts securing radio. Unplug and remove radio.  
(Figure H)

*Continue to final assembly.*

**E**

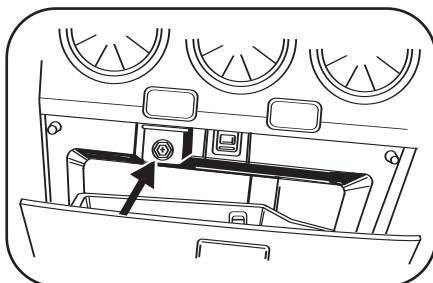

**F**

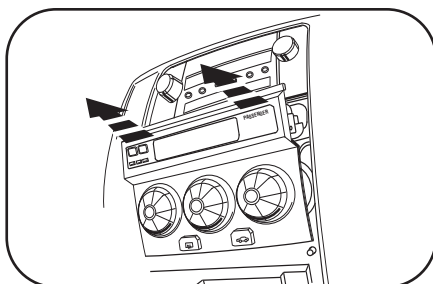

**G**

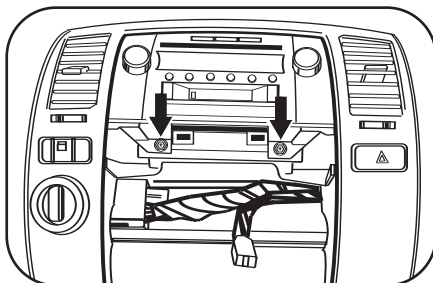

**H**

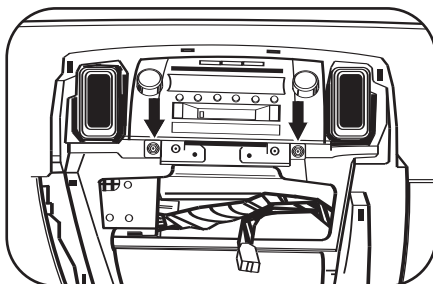

**DIN HEAD UNIT PROVISION WITH POCKET**

***\*Note: Refer also to the instructions included with the aftermarket radio.***

- 1** Slide the DIN cage into the Radio Housing and secure by bending the metal locking tabs down. (Figure A)
- 2** Slide the aftermarket head unit into the cage and secure. (Figure B)

*Continue to final assembly.*

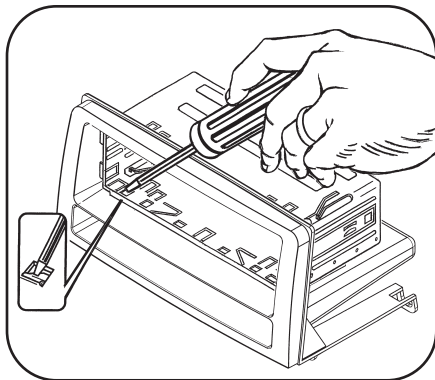
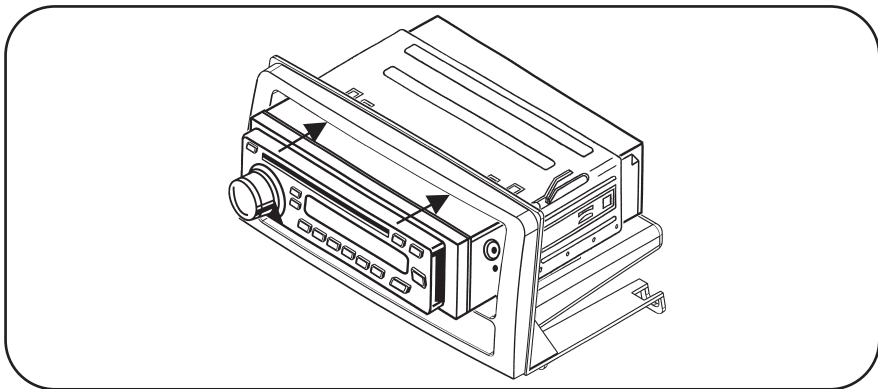
**A****B**

**ISO DIN HEAD UNIT PROVISION WITH POCKET**

*\*Note: Refer also to the instructions included with the aftermarket radio.*

- 1** Mount the ISO Brackets to the head unit with the screws supplied with the unit. (Figure A)
- 2** Slide the head unit into the radio opening until the side clips engage. (Figure B)
- 3** Snap the Trim plate into the Radio Housing. (Figure B)

*Continue to final assembly.*

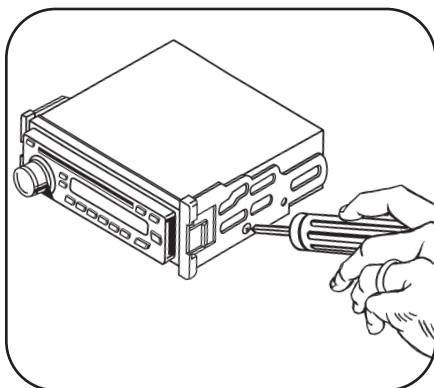
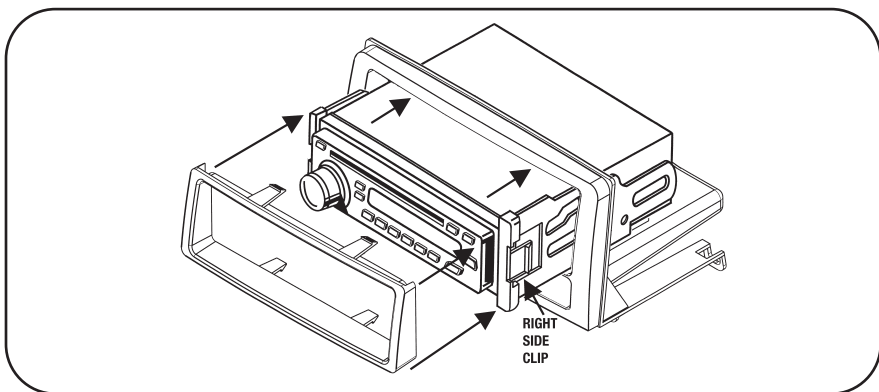
**A****B**

## **FINAL ASSEMBLY**

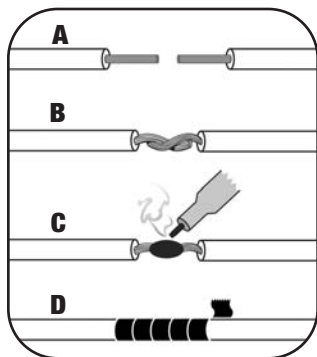

***(A) Strip wire ends back 1/2"***

***B) Twist ends together***

***C) Solder***

***D) Tape***

- 1** Locate the factory wiring harness in the dash. Metra recommends using the proper mating adapter and making connections as shown. (Isolate and individually tape off the ends of any unused wires to prevent electrical short circuit.)
- 2** Re-connect the negative battery terminal and test the unit for proper operation.
- 3** Reassemble radio and dash assemblies in reverse order of disassembly.

### **FINAL WIRING CONNECTIONS**

Make wiring connections using the EIA color code chart shown below and the instructions included with the head unit. Metra recommends making connections as shown below; Strip, Splice, Solder, Tape. Isolate and individually tape off ends of any unused wires to prevent electrical short circuit.

#### **METRA / EIA WIRING CODE**

12V Ignition / Acc. .... Red	Right Front (+) ..... Gray
12V Batt / Memory. .... Yellow	Right Front (-). .... Gray/ Black
Ground ..... Black*	Left Front (+) ..... White
Power Antenna. .... Blue	Left Front (-). .... White / Black
Amp Turn-On ..... Blue / White	Right Rear (+) ..... Violet
Amp Ground. .... Black / White	Right Rear (-) ..... Violet / Black
Illumination ..... Orange	Left Rear (+) ..... Green
Dimmer ..... Orange / White	Left Rear (-) ..... Green / Black

**\*NOTE:** When a Black wire is not present, ground radio to vehicle chassis.

All colors may not be present on all leads due to manufacturer's specifications.

## **99-8210 INSTRUCTIONS**



**1-800-221-0932**



**[www.metraonline.com](http://www.metraonline.com)**

REV. 05/17/07 © COPYRIGHT 2004-2007 METRA ELECTRONICS CORPORATION INST99-8210