



Installation instructions for part 99-8249

Toyota Camry 2015-up 99-8249

KIT FEATURES

- ISO DIN radio provision with pocket
- ISO DDIN radio provision
- *Painted to match factory finish*

KIT COMPONENTS

- A) Radio housing trim panel • B) Radio brackets • C) Pocket • D) (8) #8 x 3/8" Phillips screws

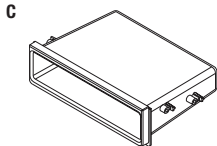
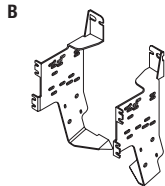
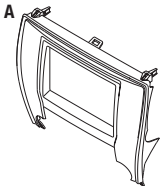

WIRING & ANTENNA CONNECTIONS (sold separately)

Wiring Harness: • 70-1761

Antenna Adapter: • 40-LX11

Table of Contents

Dash Disassembly	2-3
Kit Assembly	
– ISO DIN radio provision with pocket.....	4
– ISO DDIN radio provision	5

TOOLS REQUIRED

- Panel removal tool • Phillips screwdriver
- 10 mm nut driver or socket wrench

CAUTION: Metra recommends disconnecting the negative battery terminal before beginning any installation, unless the vehicle manufacturer recommends against so. Please check with your local Dealership for more information. All accessories, switches, climate controls panels, and especially air bag indicator lights must be connected before reconnecting the battery or cycling the ignition. Also, do not remove the factory radio with the key in the on position, or the vehicle running. It would be best to remove the key from the ignition and then wait a few seconds before removing the factory radio.

REV. 8/19/2015 INST99-8249

Dash Disassembly

1. Unclip and remove the console storage tray. (Figure A)
2. Push down on the collar below the shift knob then unscrew the shift knob. (Figure B)
3. Remove (2) Phillips screws from the shifter trim, unclip and remove the trim. (Figure C)
4. Remove (2) Phillips screws securing the factory pocket, unclip and remove the pocket. (Figure D)

Continued on next page

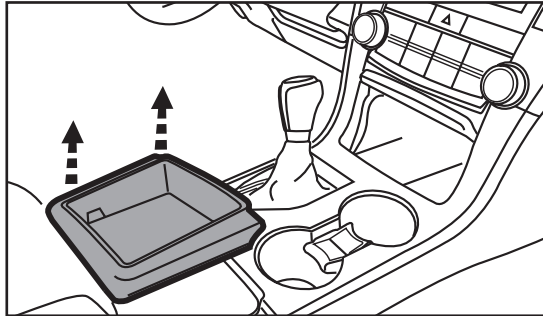

(Figure A)

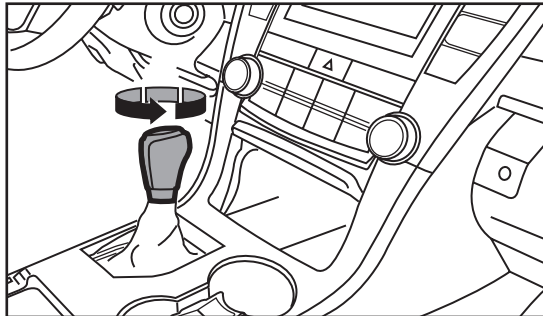

(Figure B)

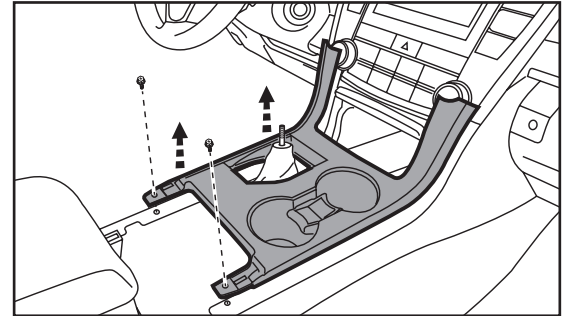

(Figure C)

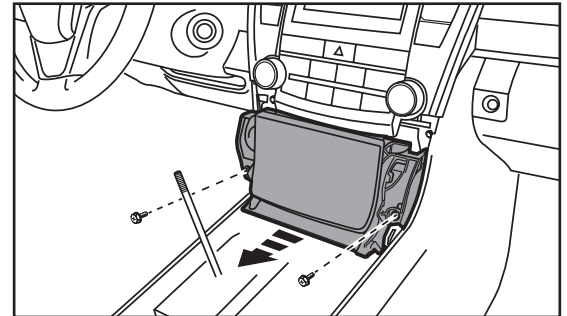

(Figure D)

Dash Disassembly

5. Unclip and remove the vent panel above the radio. (Figure E)
6. Remove (4) 10 mm bolts securing the radio and climate control assembly (2 above and 2 below). (Figure F)
7. Unplug and remove the assembly from the dash.
8. Remove (10) Phillips screws securing the factory radio brackets to the assembly. **Note: (4) Phillips screws securing the climate controls will be needed for kit assembly.**
9. Unclip the climate controls from the assembly then remove the (2) white panel clips and keep for kit assembly.

Continue to kit assembly

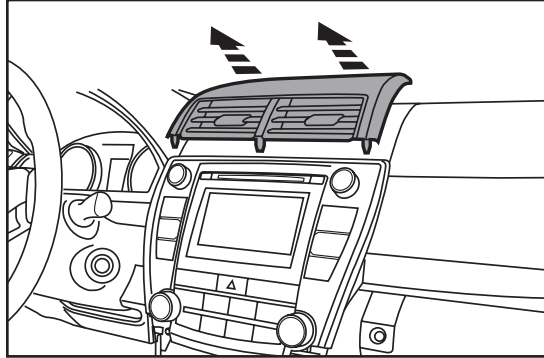

(Figure E)

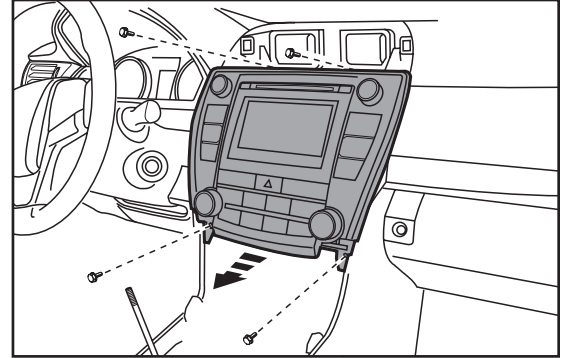

(Figure F)

Kit Assembly

ISO DIN radio provision with pocket

1. Attach the white panel clips removed in step 9 of dash disassembly to the *radio housing trim panel*.
2. Clip the climate controls onto the *radio housing trim panel*.
3. Connect the *radio brackets* to the *radio housing trim panel* with (4) #8 x 3/8" Phillips screws supplied. (Figure A)
4. Mount the *pocket* to the *bracket/panel* assembly with the (4) remaining #8 x 3/8" Phillips screws supplied. (Figure B)
5. Remove the metal "DIN" sleeve and trim ring from the aftermarket radio.

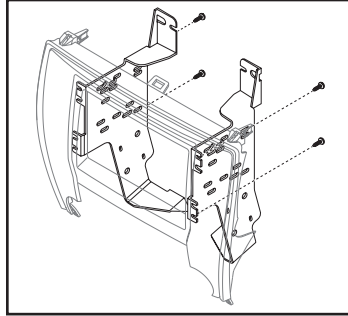

(Figure A)

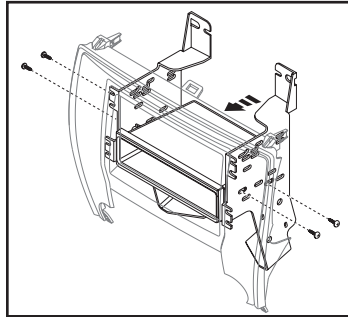

(Figure B)

6. Slide the aftermarket radio into the assembly and secure with screws supplied with the radio. (Figure C)
7. Locate the factory wiring harness and antenna connector in the dash, and complete all necessary connections to the radio. Metra recommends using the proper mating adapter from Metra and/or AXCESS. Re-connect the negative battery terminal and test the radio for proper operation.
8. Mount the new radio assembly into the dash and reassemble the dash in reverse order of disassembly.

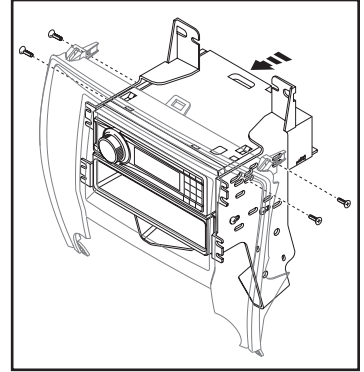

(Figure C)

Kit Assembly

ISO DDIN radio provision

1. Attach the white panel clips removed in step 9 of dash disassembly to the *radio housing trim panel*.
2. Clip the climate controls onto the *radio housing trim panel*.
3. Connect the *radio brackets* to the *radio housing trim panel* with (4) #8 x 3/8" Phillips screws supplied. (Figure A)
4. Slide the radio into the assembly and secure with screws supplied with the radio. (Figure B)

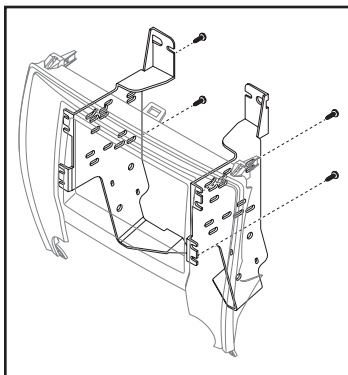

(Figure A)

5. Locate the factory wiring harness and antenna connector in the dash, and complete all necessary connections to the radio. Metra recommends using the proper mating adapter from Metra and/or AXCESS. Re-connect the negative battery terminal and test the radio for proper operation.
6. Mount the new radio assembly into the dash and reassemble the dash in reverse order of disassembly.

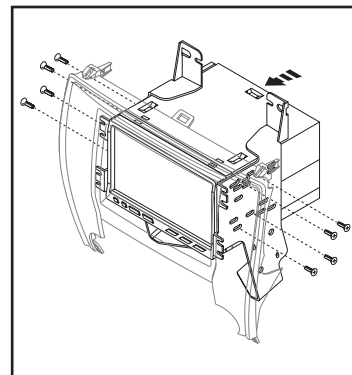

(Figure B)



Installation instructions for part 99-8249



IMPORTANT

If you are having difficulties with the installation of this product, please call our Tech Support line at 1-800-253-TECH. Before doing so, look over the instructions a second time, and make sure the installation was performed exactly as the instructions are stated. Please have the vehicle apart and ready to perform troubleshooting steps before calling.



KNOWLEDGE IS POWER

Enhance your installation and fabrication skills by enrolling in the most recognized and respected mobile electronics school in our industry. Log onto www.installerinstitute.com or call 800-354-6782 for more information and take steps toward a better tomorrow.



Metra recommends MECP certified technicians

REV. 8/19/2015 INST99-8249