

Table of Contents

BT45-ACU Package Content.....	2
Introduction & Notice	2
Compatibility Information	
Vehicle Compatibility & XM Tuner Location	3
Bluetooth Device Compatibility.....	4
Radio & Device Compatibility for Music Info Display	4
Installation	
DIP Switch Setting & Installation Quick Guide.....	5
Installation Steps & Diagrams	6
Bluetooth Setup	
Bluetooth Device Pairing Instructions.....	9
Media Audio Streaming	10
Music Playback Control.....	10
Hands Free Phone Calls	
Incoming Call	11
Outgoing Call	12
Transferring Call from HandsFree to Headset.....	13
AUX Input	13
USB Charging Port	13
Troubleshooting	14
Q & A	15

BT45-ACU Package Content

- 1 Owner's Manual
- 1 BT45 Interface Module
- 1 CAS-ACU Cable
- 1 Microphone

Introduction

The BT45 seamlessly integrates your vehicle's OEM sound system with Bluetooth (HFP) devices so you can make hands free phone calls and stream your music. You can wirelessly connect your A2DP Bluetooth profile equipped smartphone or tablet to playback stored music or stream from your favorite music apps such as Pandora or iHeart Radio. The BT45 also includes a 3.5mm auxiliary audio input so you can play back music stored in your non-Bluetooth devices.

The BT45's plug & play technology takes advantage of the OEM radio's ability to accept an external CD changer or Satellite Radio by converting it into Bluetooth phone/audio streaming/AUX input source. This design innovation allows you to maintain functionality of any of the following existing factory installed options: Bluetooth HandsFreeLink, LiveTraffic, Navigation, CD changer, Satellite radio, RSE (rear seat entertainment system), and AUX/USB input.

Notice

USA SPEC solely distributes its products through authorized dealers in order to ensure its customers receive proper services and information from the dealers. USA SPEC reserves the right to only offer technical support or warranty services for products purchased through authorized USA SPEC dealers. Please refer to our website www.usaspec.com for a list of authorized dealers.

Installation/operation precautions:

- DO read the entire manual before starting the installation. We recommend that the BT45 be installed by a qualified professional since all installations will require the removal of some parts of the vehicle such as dashboard, backseat, etc.
- DO install the interface securely using Velcro or wire ties (not included) and keep away from any moving parts such as the gas pedal.
- DO NOT open, disassemble, or modify the BT45 in any way. Such attempts will void the warranty on the product.
- DO NOT expose the interface to extreme temperature, humidity, or direct sunlight.
- DO NOT operate the Bluetooth device while driving. Always give full attention to the road while driving.

Compatibility Information

Vehicle Compatibility

Chart 1: Vehicle Compatibility & XM Tuner Location

Model	Year	XM Tuner Location
RL (Nav)	05-09	Behind the left rear quarter panel in the trunk
TL (Nav)	07-08	Behind the right rear quarter panel in the trunk
MDX (Nav)*	07-09	Right rear underneath the subwoofer
RDX (Nav)	07-09	Behind the glove box

* See p.11 for functionality exception

Use the BT45-HON3 on Canadian model vehicles without LiveTraffic

Bluetooth Device Compatibility

BT45 is compatible with most Bluetooth-enabled devices including iPhone, iPad, iPod Touch, Android smartphones & tablets, Blackberry, and Nokia Windows smartphones. Device must have Bluetooth profile A2DP (Advanced Audio Distribution Profile) and AVRCP (Audio/Video Remote Control Profile) 1.4 or higher for audio streaming and text display.

Note: Due to the difference in Bluetooth technology, some Bluetooth enabled devices may be incompatible or may not support all the features when used with a BT45.

Radio & Device Compatibility for Music Info Display

The Display of artist, album, and song title information on the radio is determined by the following 3 factors

1. Your radio has an XM button.
 - Satellite radio does not need to be activated nor does the tuner need to be present. As long as the radio has an XM button, you can get music info display.
2. Your device's operating system.

Music info display on your radio is available for:

 - iPod, iPhone, and iPad with iOS 6.0 or higher
 - Android devices with 4.0 (Ice Cream Sandwich) or higher
3. Your device's Bluetooth AVRCP profile must be 1.4 or higher. Refer to your device's product manual to confirm its profile version.

Installation

DIP Switch Setting & Installation Quick Guide

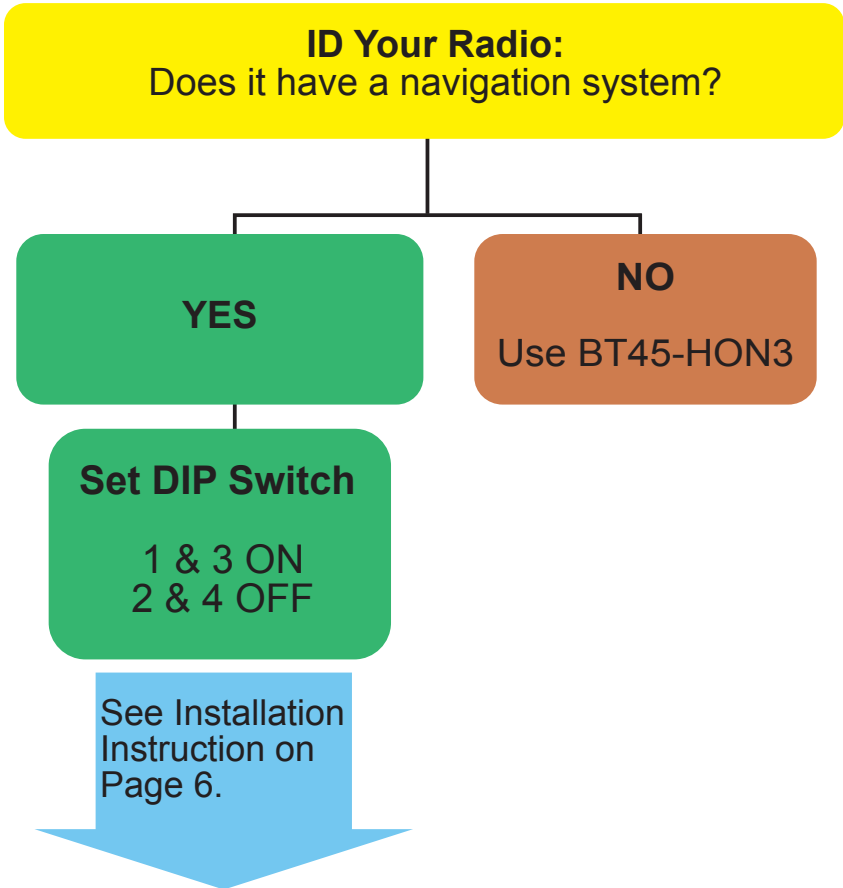

Installation Steps & Diagrams

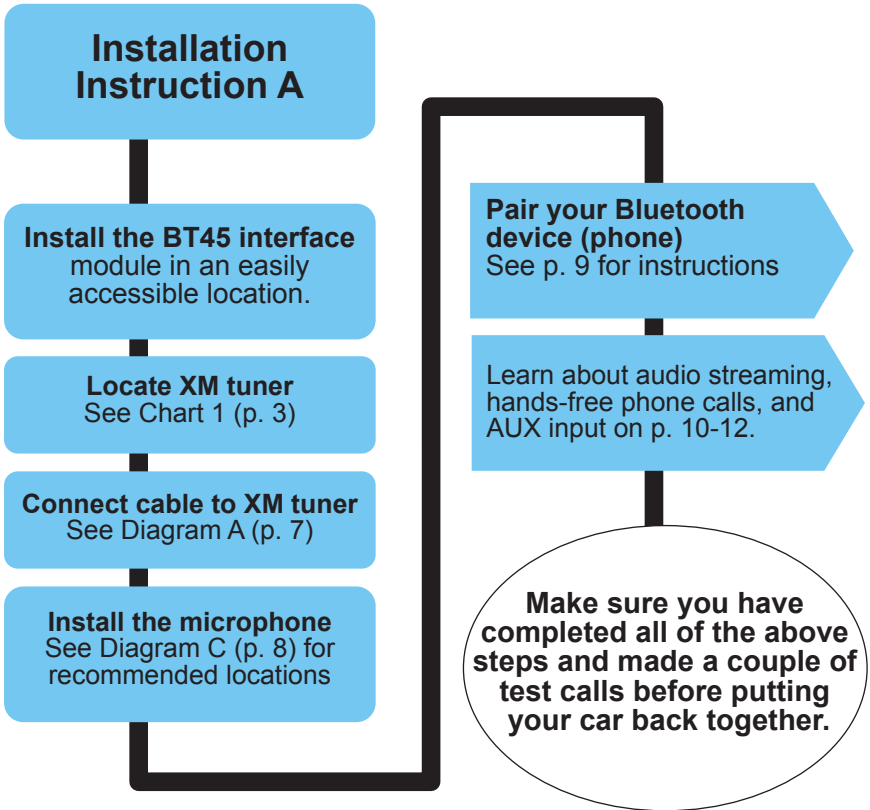

Diagram A: Cable Connections

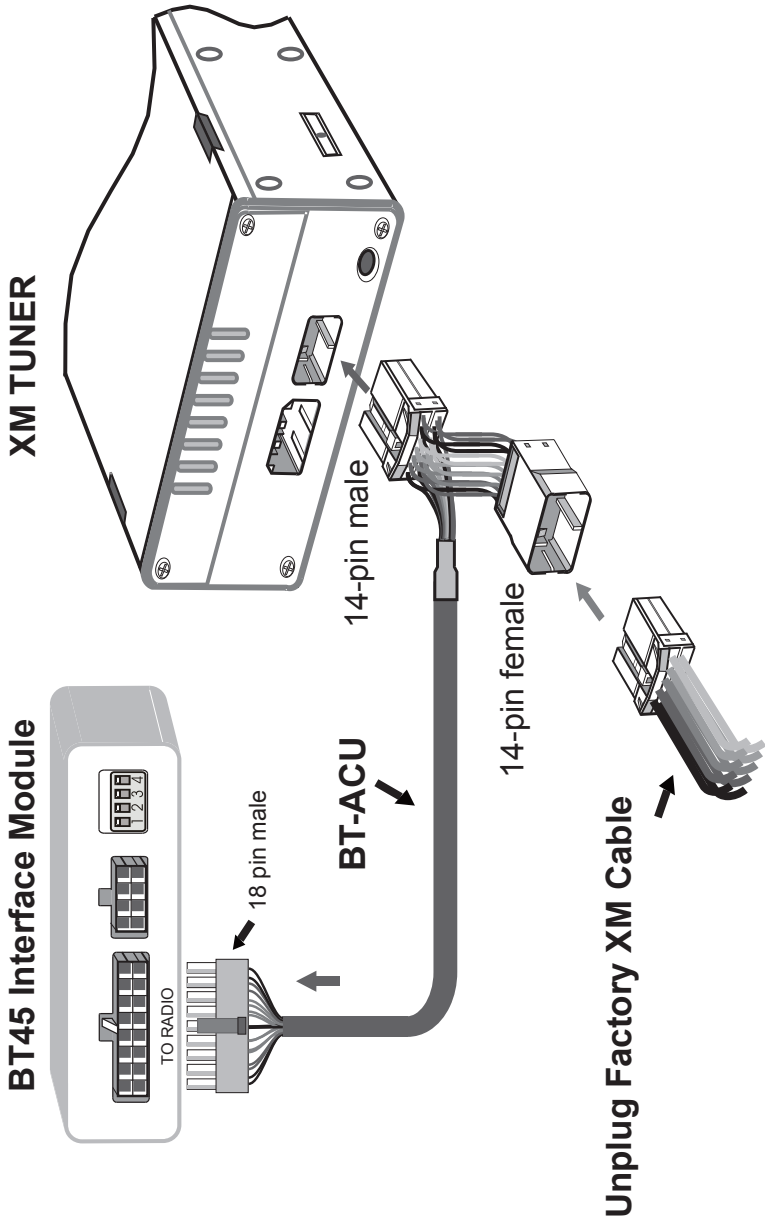
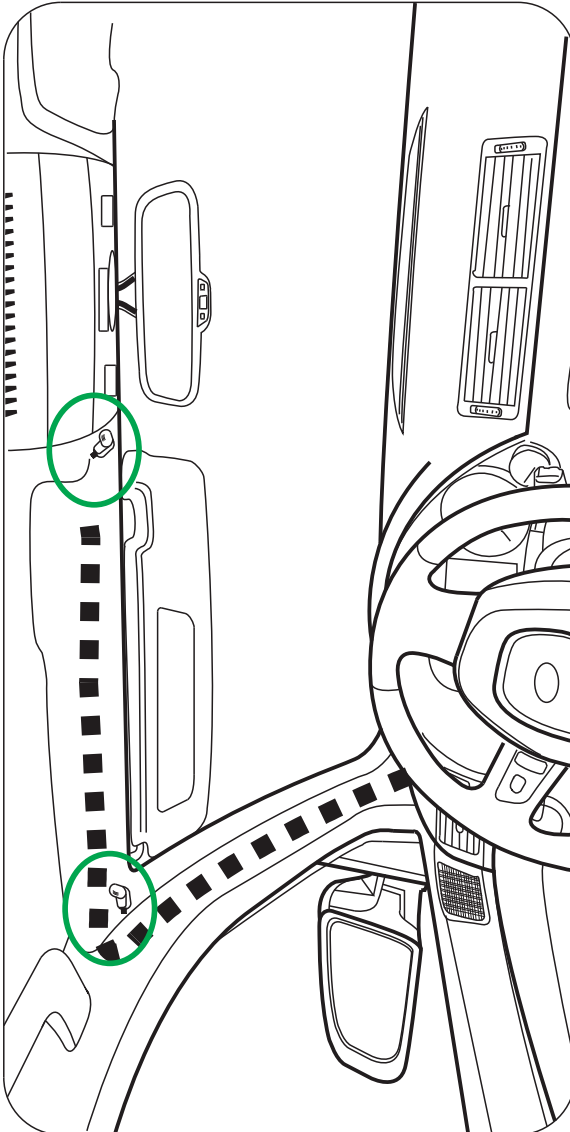

Diagram C: Recommended Microphone Locations



Bluetooth Setup

Bluetooth Device Pairing Instructions

1. Enable Bluetooth function on your device (phone).
2. Turn the vehicle's ignition ON.
3. Scan/search for available device from your phone.
 - It may take up to 60 seconds for your phone to locate the BT45-HON.

4. Select the XM1 source from your radio.
5. Select BT45-HON from the list of available devices your phone has detected.
6. Allow the pairing process to take place.
7. Once the pairing is complete you will hear the "CONNECTED" voice prompt from your vehicle's audio system and you will see your device's name displayed on the radio screen i.e. USA SPEC Test Phone.

Note: Some devices may ask for a Pin # during the pairing process.
Pairing Pin # = 1234

Media Audio Streaming

Device requires Bluetooth A2DP profile

- If you have music stored in your device, it will begin to play right after the "CONNECTED" voice prompt. If playback doesn't start automatically, press TUNE UP or TRACK/SEEK UP to initiate playback.
- You can also proceed to access your favorite music/media app such as Pandora or Podcast app directly from your device.

Device with AVRCP 1.4 & higher
Radio will display music information such as artist, album, and song title.

Device with older AVRCP profile
Radio will display [NO TEXT] and the BT45 will assign track numbers to the currently playing music.

When you pause the music, radio will display [PAUSED].

Music Playback Control

Playback control from your radio (Track Up/Down)

Device requires Bluetooth AVRCP profile

- **From radio:**
Press TUNE UP/DOWN button(s)/knob.
- **From steering wheel:**
Press CH +/- button. In some vehicles you may need to press & hold the CH +/- button.
- After you pause the music, and the radio display says [PAUSED], you can use the TUNE UP button/knob to start playback.

Hands Free Phone Calls

Incoming Call

1. The BT45 will mute the audio source (AM/FM, CD, XM, or AUX) you are listening to.
2. You'll hear "You have a call from (Caller's phone #)" or "Private" if Caller ID is not available. If the voice prompt* is disabled, you'll only hear the phone ringtone.

Radio will display incoming call's number or [PRIVATE]

To Answer the Call**

From radio: Press TUNE UP button/knob

From steering wheel:

Press CH+ button. In some vehicles you may need to press & hold the CH+ button.

Note: If a phone call comes in while you're in XM2, you must go to XM1 first then press the TUNE UP or CH+ button to answer the call.

Once the call is answered, radio will display [ACTIVE].

To Reject or End the call

Press TUNE DOWN radio button or or CH- steering wheel button

MDX (Nav) 07-09 Note

BT45-ACU will not auto-mute the radio upon an incoming call. You must manually switch to XM1 first in order to answer the call using either radio or steering wheel button.

*How to Enable/Disable Voice Prompt

- Turn engine ON
- Start audio streaming
- While streaming turn Bluetooth off from your phone/device's setting.
- Wait 5-10 seconds, turn TUNE button/knob to the right to ENABLE and turn to the left to DISABLE.

Outgoing Call

Initiate the call from
your phone

BT45 will mute the audio
source you're listening to and
automatically switch over to
Bluetooth mode.

To End the Call

From radio:
Press TUNE DOWN
button/knob

From Steering Wheel:
Press CH- button. In some
vehicles you may need to hold
& press the CH- button.

Transferring an active call from Hands-free to Handset

From radio: Press TUNE UP button

From Steering wheel: Press CH+ button

Press the same button again to transfer the call back to the Bluetooth Hands-Free mode.

AUX Input

Aux 3.5 mm Audio Input

1. You'll need a 3.5mm to headphone jack cable (not included in this package)
2. Make sure DIP switch #1 is set to ON

Go to XM1 then press **Preset 6** to access the audio device connected to the AUX port.

Note: Remember to manually adjust the volume of your audio device to MAX after it's been connected.

USB Charging Port

**Maximum charging output: 2.1 amps at 5 volt
(charging cable not provided)**

Troubleshooting

- **I'm unable to pair my smartphone/device.**

If you have an Android device, make sure the "Only visible to paired devices" option is UNCHECKED. Sometimes it can take up to 30 seconds for the BT45 to be detected by your smartphone/device.

- **My radio is not displaying any music info such as song titles.**

Confirm that your device is equipped with Bluetooth profile AVRCP 1.4 or higher, it has iOS 6.0 or higher, or Android 4.0 or higher.

Music streaming apps' info display capabilities vary thus some might not display properly on your radio.

- **The BT45's USB port will not charge my device.**

Please use data SYNC and CHARGE (USB 2.0 capability) cables. Not all USB cables on the market support charging.

- **I connected all the cables properly in my RL but the BT45-ACU is still not functioning.**

Make sure you've connected to the XM tuner (see p.3 for location) and not the CD ROM underneath the rear deck.

- **I have a device connected through BT45's AUX input and the volume is very low.**

Turn the volume on the actual device to MAX then use the radio's volume control to adjust the level.

Q&A

- **I already have a USA SPEC PA15-ACUxl installed in my Acura, can I have both a BT45-ACU and a P15-ACUxl connected in my vehicle?**

No, unfortunately you can only have one or the other.

- **Do I lose my XM functions since XM1 is now for Bluetooth?**

No, you're only losing the presets under XM1. You can still access your Satellite radio through XM2.

- **My vehicle is equipped with factory HandsFree Bluetooth, is the BT45-ACU still compatible?**

Yes, for a smoother operational experience we recommend that you un-pair the factory Bluetooth from your smartphone/device and use the BT45-ACU only. However, you do have the option to set your Android device to use BT45 for media audio only and use the factory Bluetooth for Handsfree phone calls.

LIMITED WARRANTY

Thank you for choosing a USA SPEC product. USA SPEC, Inc., is committed to providing high quality defect-free products. All USA SPEC products are tested before leaving the factory and warranted against defects in materials and workmanship for a period of one year to the original owner. The one-year warranty period begins at the date of purchase from an authorized dealer.

PRODUCTS COVERED:

Products and related accessories supplied by USA SPEC, Inc. with the brand name of USA SPEC are covered by this warranty. Only products purchased in the USA are covered.

WARRANTY DOES NOT COVER:

1. Damage due to improper installation or operation, negligence, abuse, or not following instructions, warnings or acceptable industry procedures.
2. Damage caused during the shipment or transportation of the product. All claims of this nature must be presented to the carrier.
3. Damage caused by acts of God, war, or civil disturbance, including without limitation, flood, fire, storms, earthquake or other acts of nature.
4. Any expenses or cost to remove or reinstall products.
5. Any product without the original serial number and factory seal, or has been serviced or modified without the authorization of USA SPEC.
6. Any product not distributed by an authorized USA SPEC dealer.

TO OBTAIN WARRANTY SERVICE:

Contact the Customer Service center for assistance at (626) 336 - 3836. A detailed description of the problem(s) is required for service. Proof of purchase is also required when sending a product for warranty service. If the problem cannot be resolved and the product must be returned for service, you will receive an authorization form from the service center. The product must be delivered pre-paid to the service center. USA SPEC will, at our option, repair the product or replace it with a new or reconditioned product, and if it was shipped to the service center, the return shipping will be pre-paid free of charge provided the repairs are covered by the warranty. The product must be packed securely for shipment to the service center in order to preserve the warranty and prevent damage.

NO IMPLIED WARRANTY, INCLUDING MERCHANTABILITY AND FITNESS FOR USE APPLIES TO THIS PRODUCT AFTER THE ONE YEAR PERIOD AS DEFINED ABOVE, AND NO OTHER EXPRESSED WARRANTY OR GUARANTEE, EXCEPT AS MENTIONED ABOVE, GIVEN BY ANY PERSON, FIRM, OR CORPORATION WITH RESPECT TO THIS PRODUCT SHALL BIND THE WARRANTOR. NEITHER THE WARRANTOR NOR ANY OTHER PERSON, FIRM, OR CORPORATION IS RESPONSIBLE FOR LOSSES OR INCONVENIENCES, OR FOR ANY CONSEQUENTIAL DAMAGES CAUSED BY THE PRODUCT. SOME STATES/PROVINCES DO NOT ALLOW LIMITATIONS ON HOW LONG AN IMPLIED WARRANTY LASTS, AND SOME DO NOT ALLOW THE EXCLUSION OR LIMITATION OF INCIDENTAL OR CONSEQUENTIAL DAMAGES.

This warranty gives you specific legal rights, and you may also have other rights, which vary, from state to state, and province to province. Some of the limitations or exclusions may not apply to you. THE ABOVE WARRANTY TERMS AND CONDITIONS ARE VALID ONLY IN THE U.S.A.