

NAV-TV

www.nav-tv.com

100 NW 11th street, Boca Raton, FL 33432

Tel. 561-955-9770 Fax. 561-955-9760

info@nav-tv.com

NTG3 / NTG3E / NTG3SLK

2009-up Mercedes GL/ML/R/E/CLS/SLK New Generation
Backup camera / AV input / RSE / Video In Motion interface

Product Description



Thank you for purchasing the NTG3, a multi-featured integration interface designed specifically for 2009 Model Year Mercedes Vehicles equipped with next-generation radios.

Backup Camera: Vehicles not equipped with a Backup Camera can be retrofitted with a Camera in an OEM fashion. Programming is done via the NTG3 interface, All required wiring is included; OEM-Grade Cameras are available separately from NAV-TV.

Rear Seat Entertainment: Adding Rear screens, headphones and rear DVD players could not be easier. The NTG3 interface comes standard with zoned A/V outputs. The front DVD player can be used to drive rear screens, even while the driver is listening to Radio, HD, MP3's, iPod or SAT radio. Rear passengers can enjoy iPod, Radio or SAT music while the driver listens to CD's. Additionally, a rear mounted DVD player or Video iPod could be routed to the radio for Front passenger entertainment (Not for the driver's use while operating the vehicle, see Agreement below). An additional AUX Audio input labeled REAR is available as well for CE devices such as Music players.

Video-in-motion: Where applicable by law, and for passenger use only, Front DVD and AUX video could be enabled while the vehicle is in motion. Please do not drive and watch movies! it is illegal in many states and most importantly - dangerous.

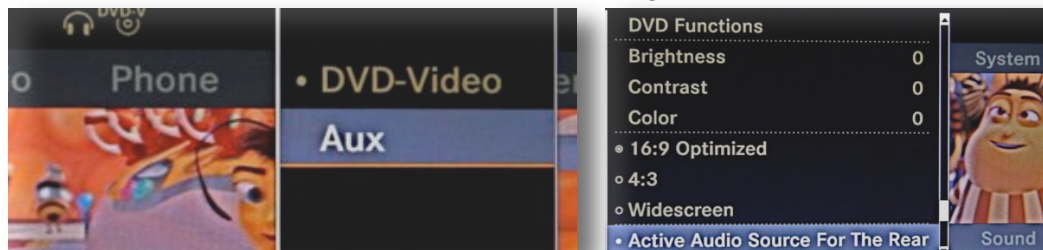

WARNING: Check entire surroundings while backing. Do not become distracted by using COMAND.

Agreement: End user agrees to use this product in compliance with all State and Federal laws. NAV-TV Corp. Would not be held liable for misuse of it's product. If you do not agree, please discontinue use immediately and return product to place of purchase.

This product is intended for off-road use and passenger entertainment only.

NAV-TV

www.nav-tv.com





100 NW 11th street, Boca Raton, FL 33432

Tel. 561-955-9770 Fax. 561-955-9760

info@nav-tv.com

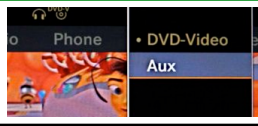
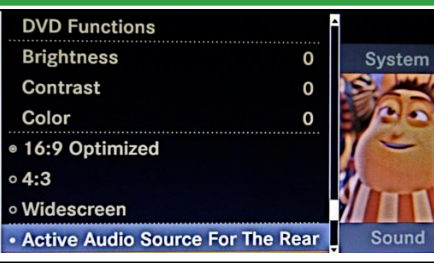
NTG3 / NTG3E /NTG3SLK

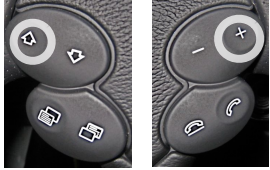
2009-up Mercedes GL/ML/R/E/CLS/SLK New Generation Backup camera / AV input / RSE / Video In Motion interface **Operation Instructions**

<p>To Activate Rear View Camera</p>	<p>Fig. 1 - Vehicle in Reverse</p>
<p>With the brake depressed and engine running, engage reverse gear.</p>	
<p>Rear View Camera will show on radio screen.</p>	
<p>To Activate AUX Video</p>	<p>Fig. 2 - AUX Video</p>
<p>Select "Video" Select "Aux"</p>	
<p>To Set Active Audio Source For the Rear</p>	<p>Fig. 3 - RSE</p>
<p>Select the source name at the bottom-left of the screen (example - "DVD-Video") Select "Activate Audio Source For The Rear" <i>Selected Audio source and DVD / AUX Video are now available for rear headphones and screens (if installed)</i></p>	
<p>To Activate Video in motion (GL, ML, R Class)</p>	<p>Fig. 4 - Video in motion</p>
<p>Double click the  (Voice Off) button. Repeat to de-activate video in motion. <i>NOTE: Navigation does not track while VIM is active.</i></p>	
<p>To activate Video in motion (E, CLS, SL Class)</p>	<p>Fig. 5 - Video in motion</p>
<p>Press VOL UP and SEEK UP simultaneously. Repeat to de-activate video in motion. <i>NOTE: Navigation does not track while VIM is active.</i></p>	
<p>To activate Video in motion (SLK Class)</p>	<p>Fig. 6 - Video in motion</p>
<p>Press VOL UP and VOL DOWN simultaneously. Repeat to de-activate video in motion. <i>NOTE: Navigation does not track while VIM is active.</i></p>	

NAV-TV

www.nav-tv.com

100 NW 11th street, Boca Raton, FL 33432

Tel. 561-955-9770 Fax. 561-955-9760

info@nav-tv.com

NTG3 / NTG3E / NTG3SLK Installation Instructions

Remove Radio

1. Remove 2 TORX T20 Screws behind ashtray, unplug and remove ashtray.
2. Using a plastic trim tool, carefully pop out A/C control trim, Then unplug.
3. Remove 2 TORX T20 screws below radio, then move metal locking tabs DOWN.
4. Pull radio out and unplug.

Fig. 1 - Radio Removal (GL)

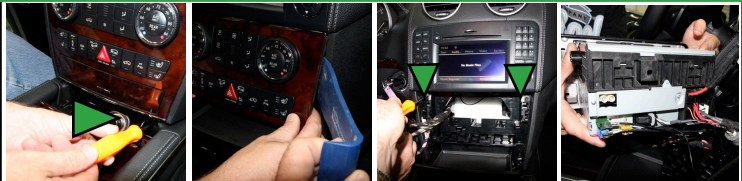

Wiring - NTG3

1. Unplug factory power connector from radio.
2. Remove Fiber connector from factory plug by releasing the latch and pulling the connector outwards. Plug Fiber connector into supplied plug and play harness connector.
3. Plug in the NTG3 adapter harness to factory harness, Radio and NTG3 Module.
4. If adding Rear-view Camera: Plug video cable to Green FAKRA, Connect to Camera.
5. Plug supplied A/V harness into Black 18-pin connector. connect as needed: A/V out, AUX Video in, Secondary (RSE) Audio in.
6. For your convenience, The following OUTPUTS are included. DO NOT EXCEED 500mA !!!
White / Purple: +12V VIM Mode, 500mA
White / Green: +12V Acc. OUT, 500mA
(connect to Camera or turn on for RSE)

Fig. 2 - Plugs at rear of Radio

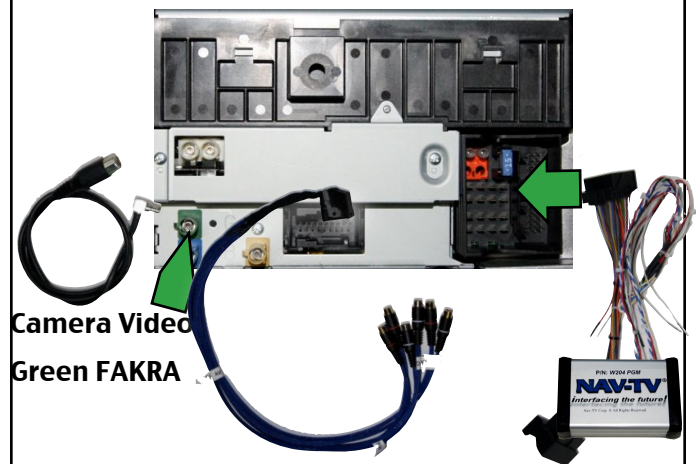

NOTE: The 3.5mm Audio jack in the glovebox is shared for both AUX modes, AUX Audio and AUX VIDEO. If installing an additional A/V source such as Video ipod, Rear DVD Player etc., the AUX Audio port will be occupied.

We advise to use the secondary AUX Audio Labeled "REAR" on the AUDIO Menu as a substitute AUX Audio source and run a new 3.5mm jack or Stereo RCA's to the glovebox (Jacks not included).

Please inform your customer of the changes if needed.

NAV-TV

www.nav-tv.com

100 NW 11th street, Boca Raton, FL 33432

Tel. 561-955-9770 Fax. 561-955-9760

info@nav-tv.com

NTG3 / NTG3E / NTG3SLK Programming Instructions

**Note: Prior to programming,
Shut the vehicle off and remove the key for 30 seconds, Then turn the key to IGN ON.**

Rear View Camera		GL, ML, R Class		All Features		E & CLS	
ON: Press and hold 6 seconds: VR OFF + TALK				ON: Press and hold 30 seconds: VOL UP + SEEK UP			
OFF: Press and hold 6 seconds VR + TALK				OFF: Factory Reset E & CLS Press and hold 30 seconds: VOL DOWN + SEEK DOWN			
RSE		GL, ML, R Class		All Features		SLK	
ON: Press and hold 6 seconds: VR OFF + VOL DOWN				ON: Press and hold 30 seconds: TALK + HANG			
OFF: Press and hold 6 seconds: VR + VOL DOWN				OFF: Factory Reset SLK Press and hold 30 seconds: UP + DOWN			
AUX Video		GL, ML, R Class		<div style="background-color: #4CAF50; color: white; padding: 10px; border-radius: 15px; text-align: center;"> <p>During programming, the radio screen will display DIAGNOSIS, Then restart.</p> </div> <div style="background-color: #F44336; color: white; padding: 10px; border-radius: 15px; text-align: center; margin-top: 10px;"> <p>Important Note: NTG3 Must learn the VIN and can not be re-installed in a different vehicle unless original vehicle has been reset to factory settings!</p> </div>			
ON: Press and hold 6 seconds: VR OFF + HANG							
OFF: Press and hold 6 seconds: VR + HANG							
Factory Reset		GL, ML, R Class					
Press and hold 30 seconds: VR OFF + VR							

NAV-TV

INTERFACING THE FUTURE

100 NW 11th Street, Boca Raton, FL 33432 TEL 561-955-9770 FAX 561-955-9760

www.nav-tv.com

info@nav-tv.com

NTG3 PRODUCT UPDATE

FOR VEHICLES WITH RSE - TO ADD VIDEO IN AND VIDEO OUT

Overview-

This is an amendment to the existing documentation for vehicles with Rear Seat Entertainment (RSE). In which the customer wants to add audio/video in through the AUX port of the radio, without purchasing the Mercedes-Benz part.

Video in modification -

1. Remove the 18 pin RSE connector from behind radio.
2. Once removed, the connector cover needs to come off to gain access to the pins for removal.
3. Remove pins 1 and 2 from the factory connector. Be sure to insulate the wires (tape or heat shrink).

NOTE: The wire being removed will have a FAKRA connector on it 3" down.

4. Do the same procedure on the NAV-TV NTG3 video connector.
5. Re-insert the removed RCA from the NAV-TV connector and plug it into the factory connector, pins 1 and 2.

NOTE: Be sure that the signal of the RCA goes into pin 1 and the shield into pin 2.

6. Re-assemble the connector and plug it back into the radio.



Audio In -

If vehicle has UCI – Multimedia Interface for Ipod

- Audio will still be introduced via the 1/8" jack in the glove box using a 1/8" stereo audio jack.

If vehicle doesn't have UCI –

- You need to remove the RCA's from the 18 way NAV-TV connector. Once removed, re-insert into the factory connector in the following pin locations.
- Pin 8 – Audio Shield Pin 9 – Left Audio Pin 18 – Right Audio

Video Out –

If video out is desired, using a cut RCA, solder the center conductor (video feed) to wire in pin position 5. The shield of the RCA gets soldered to the wire in pin position 6. Be sure to properly insulate connections. All connections are made at the factory 18 pin RSE connector behind the radio.

Removal of pins from connector –

1. Using a small screw driver or pick tool, gently depress the pin release and pull wire back to remove from connector.
2. Before you reinsert the wire into the factory connector, be sure that the tab is pulled up just a little bit so that it will catch when it is reinserted into the factory connector.

