



INSTALLATION INSTRUCTIONS FOR PART 99-7422

APPLICATIONS

Nissan Sentra 2007

99-7422

KIT FEATURES

- DIN Radio Provision with Pocket
- Double DIN Radio Provision
- Stacked ISO Mount Units Provision



KIT COMPONENTS

- A) Radio Housing • B) Radio Housing Trimplate • C) Radio Housing Brackets
• D) Double DIN Trim Plate • E) (2) Carriage Bolts • F) (2) Nuts

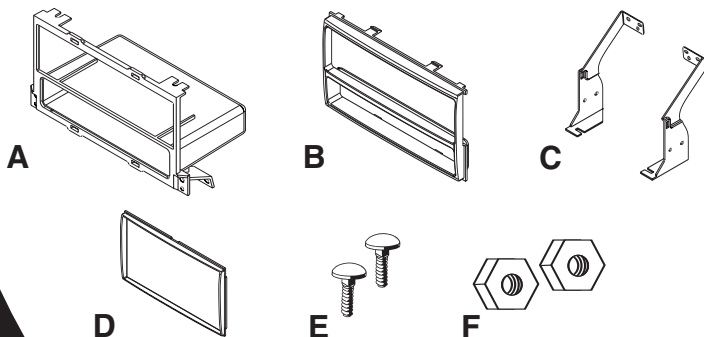

TOOLS REQUIRED:

- Small Flat Blade Screwdriver/ Panel Removal Tool
• Phillips Screwdriver • Hook Tool • Socket Set



1-800-221-0932



www.metraonline.com

© COPYRIGHT 2004 METRA ELECTRONICS CORPORATION



TABLE OF CONTENTS

Dash Disassembly

- Nissan Sentra 2007	1,2
----------------------------	-----

Kit Assembly

- Kit Preparation (For DIN radio with pocket only)	3
- DIN Radio Provision with Pocket	4
- Double DIN Radio Provision	5
- Stacked ISO Mount Units Provision	6

<u>Final Assembly</u>	7
------------------------------------	---

***Note:**

Refer also to the instructions included with the aftermarket radio.

NISSAN SENTRA 2007

- 1** Disconnect the negative battery terminal to prevent an accidental short circuit.
- 2** Push down on the collar below the shift knob to unclip. Using a small screwdriver or hook tool remove the spring clip to release and remove the shift knob. (Figure A)
- 3** Unclip and remove shifter trim panel around shifter. (Figure B)
- 4** Unclip and remove the a/c control panel. (Figure C)
- 5** Remove (2) Phillips screws securing the bottom of the radio trim panel. (Figure D)

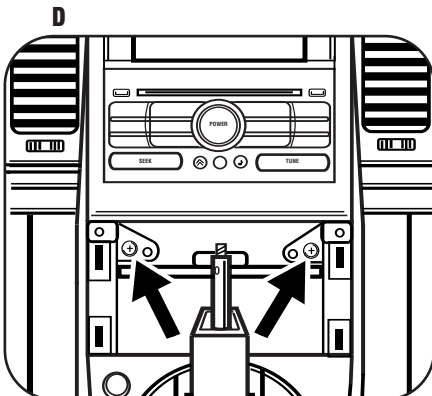
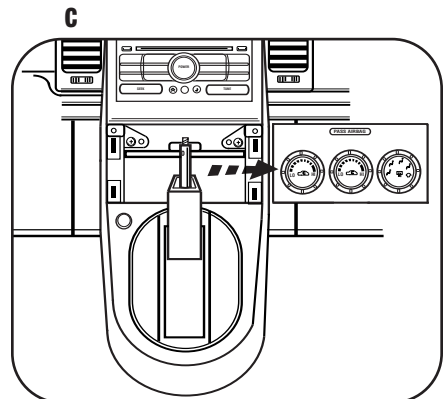
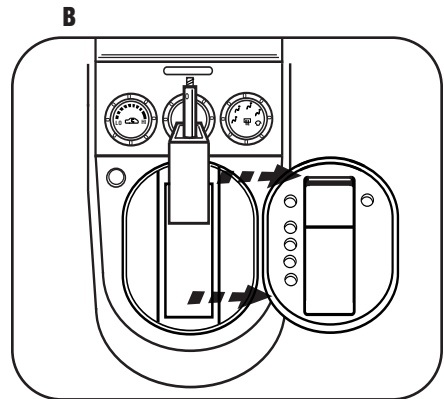
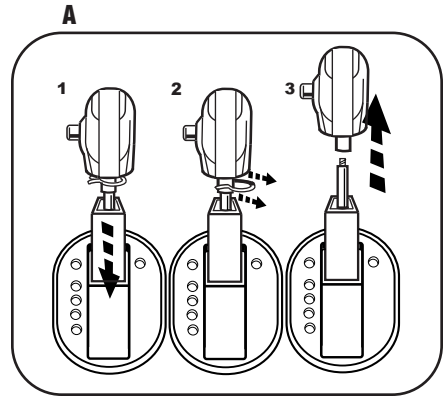

NISSAN SENTRA 2007

- 6** Unclip and remove the trim panel at the top of the radio trim panel.
(Figure E)
- 7** Remove (2) Phillips screws securing the top of the radio trim panel.
(Figure F)
- 8** Unplug and remove radio/trim panel assembly. (Figure G)
- 9** Remove (4) Phillips screws securing the radio brackets to the trim panel and remove the trim panel.
- 10** Remove (6) Phillips screws (3 per side) securing the factory brackets to the radio/display assembly. (Retain the factory brackets and display for possible use during kit assembly.)

Continue to kit assembly.

E

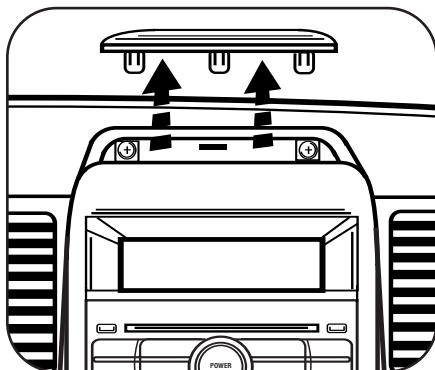

F

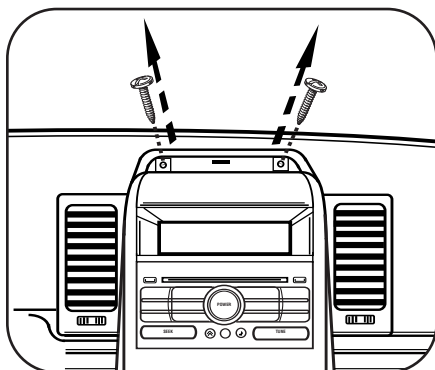

G

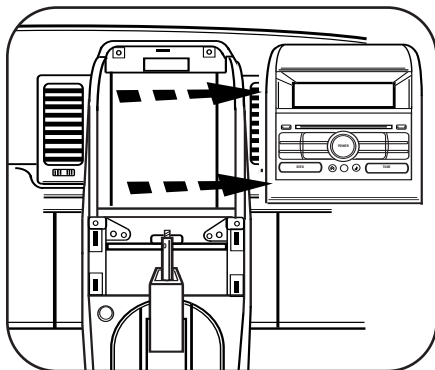

KIT PREPARATION (FOR DIN RADIO WITH POCKET ONLY)

****Note:** Refer also to the instructions included with the aftermarket radio.*

- 1 Attach the (2) radio housing brackets to the radio housing using the supplied (2) carriage bolts and nuts. (Figure A)
- 2 Secure the display* into the assembled radio housing/bracket assembly using the factory hardware. (Figure B)

***NOTE:** Display can be replaced with Metra's Pocket, Part number 88-00-7422 sold separately.

Continue to final assembly.

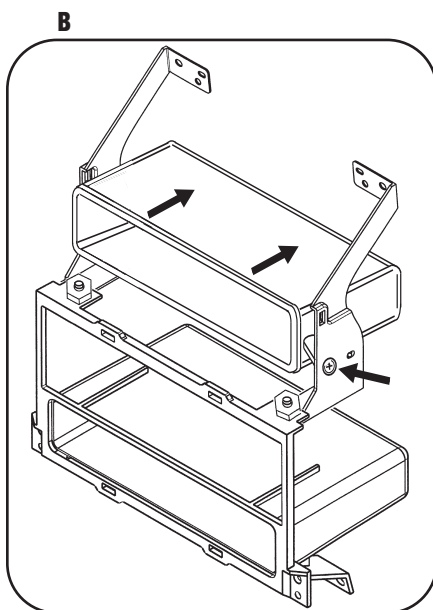
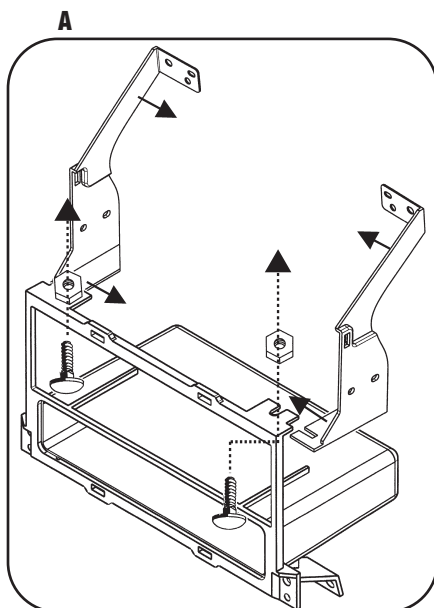

DIN RADIO PROVISION WITH POCKET

****Note:** Refer also to the instructions included with the aftermarket radio.*

- 1** Slide the DIN cage into the Radio Housing and secure by bending the metal locking outward. (Figure A)
- 2** Slide the aftermarket radio into the cage until it snaps into place. (Figure B)
- 3** Attach the radio housing trim plate supplied with the kit. (Figure B)

NOTE: Display can be replaced with Metra's Pocket, Part number 88-00-7422 sold separately.

Continue to final assembly.

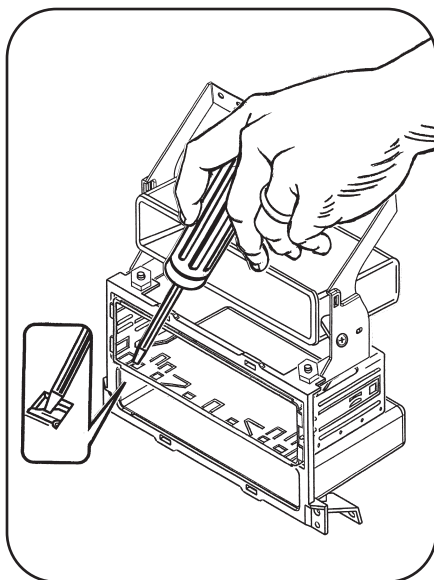
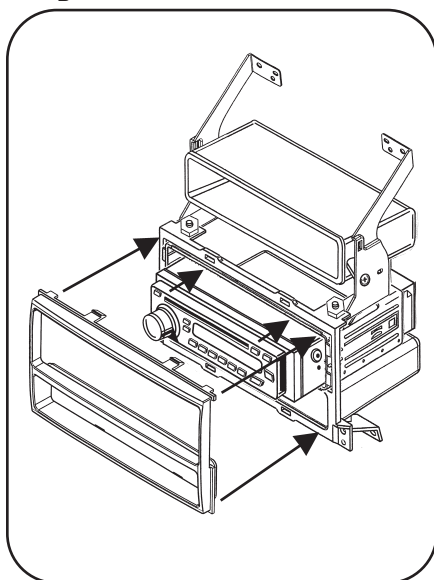
A**B**

DOUBLE DIN RADIO PROVISION

**Note: Refer also to the instructions included with the aftermarket radio.*

- 1 Re-Secure the display* to the factory brackets using the factory hardware. (Figure A)
- 2 Slide the Double DIN radio into the factory brackets and secure the unit to the brackets using the screws supplied with the radio. (Figure B)
- 3 Place the Double DIN trim plate over the face of the aftermarket radio. (Figure B)

***NOTE:** Display can be replaced with Metra's Pocket, Part number 88-00-7422 sold separately.

Continue to final assembly.

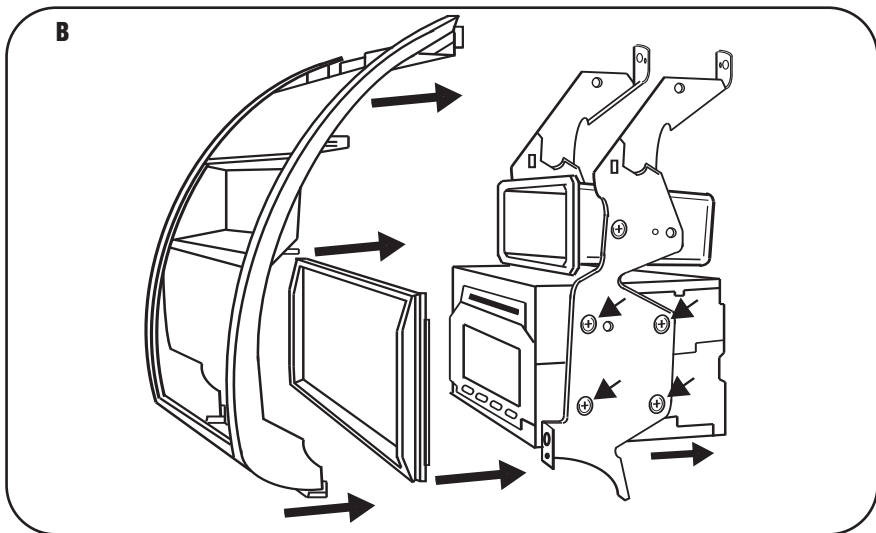
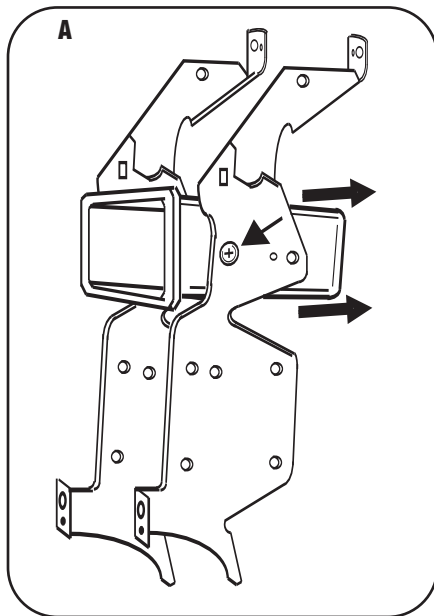

STACKED ISO MOUNT UNITS PROVISION

****Note: Refer also to the instructions included with the aftermarket radio.***

- 1** Re-Secure the display* to the factory brackets using the factory hardware. (Figure A)
- 2** Slide the stacked ISO Mount units into the factory bracket/display assembly and secure the units to the assembly using the screws supplied with the units. (Figure B)
- 3** Place the Double DIN trim plate over the face of the units. (Figure B)

***NOTE:** Display can be replaced with Metra's Pocket, Part number 88-00-7422 sold separately.

Continue to final assembly.

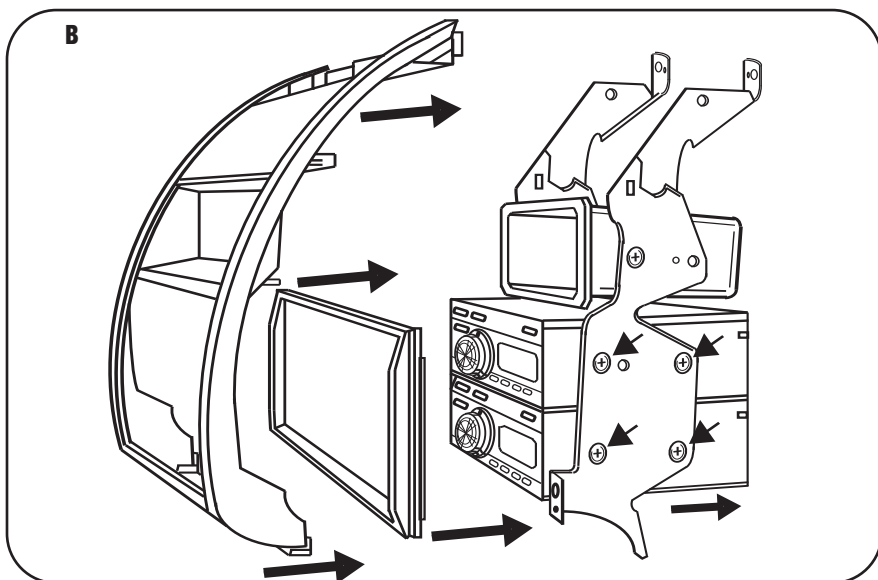
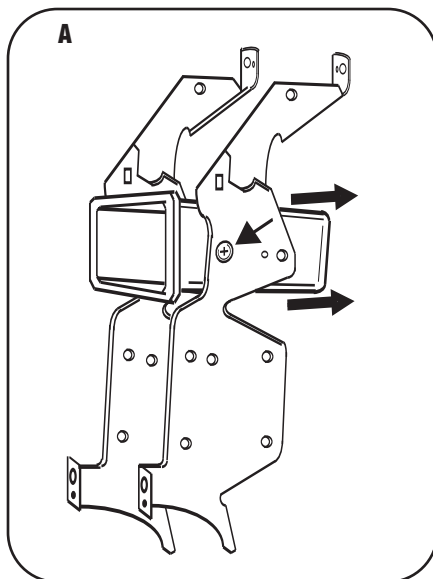

FINAL ASSEMBLY

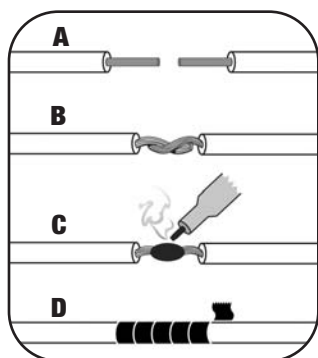

(A) Strip wire ends back 1/2"

B) Twist ends together

C) Solder

D) Tape

- 1** Locate the factory wiring harness in the dash. Metra recommends using the proper mating adapter and making connections as shown. (Isolate and individually tape off the ends of any unused wires to prevent electrical short circuit.)
- 2** Re-connect the negative battery terminal and test the unit for proper operation.
- 3** Reassemble radio and dash assemblies in reverse order of disassembly.

FINAL WIRING CONNECTIONS

Make wiring connections using the EIA color code chart shown below and the instructions included with the head unit. Metra recommends making connections as shown below; Strip, Splice, Solder, Tape. Isolate and individually tape off ends of any unused wires to prevent electrical short circuit.

METRA / EIA WIRING CODE

12V Ignition / Acc. Red

12V Batt / Memory. Yellow

Ground Black*

Power Antenna. Blue

Amp Turn-On Blue / White

Amp Ground. Black / White

Illumination Orange

Dimmer Orange / White

Right Front (+) Gray

Right Front (-). Gray/ Black

Left Front (+) White

Left Front (-). White / Black

Right Rear (+) Violet

Right Rear (-). Violet / Black

Left Rear (+) Green

Left Rear (-). Green / Black

***NOTE:** When a Black wire is not present, ground radio to vehicle chassis.

All colors may not be present on all leads due to manufacturer's specifications.

This image shows a single sheet of white paper with horizontal blue or grey ruling lines, typical of notebook paper. The lines are evenly spaced and run across the width of the page. There are no margins, text, or other markings on the paper.



99-7422

NOTES

This image shows a single sheet of white paper with horizontal ruling lines. The lines are evenly spaced and run across the width of the page. There are no margins, text, or other markings on the paper.

99-7422 INSTRUCTIONS



1-800-221-0932



www.metraonline.com

REV. 01/23/07 © COPYRIGHT 2004 METRA ELECTRONICS CORPORATION

INST99-7422